

STANDARD DUTY DOOR CLOSER DC6114/DC6126

ANSI/BHMA Grade 1

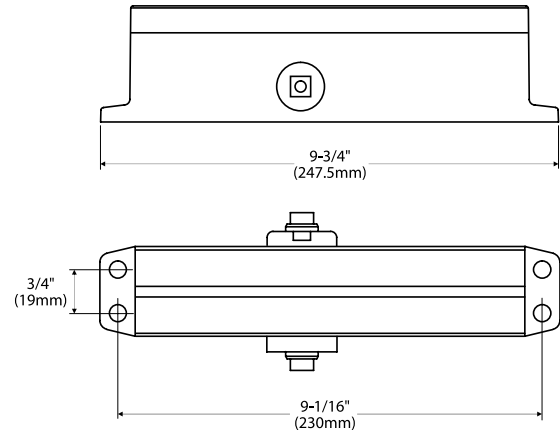
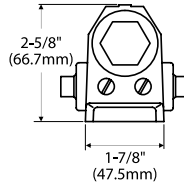

SPECIFICATIONS

DC6114 Adjustable Power Size	1 Thru 4; meets ADA Barrier-Free requirements
DC6126 Adjustable Power Size	2 Thru 6
Body	One piece Aluminum Alloy Body
Design	Rack-and-Pinion
Valves	Separate and independent latch, sweep and back-check pressure valves
Handing	Non-Handed
Cover	Standard Closer comes Less Cover; optional Slim Cover available by special order
Packing	Tri-packed
Piston	34mm (1-11/32") diameter
Pinion Journals	16mm (5/8") diameter
Projection	66.7mm (2-5/8"), without cover

CODE COMPLIANCE



ANSI/BHMA A156.4 Grade 1 Closers
 ANSI A117.1 ADA Accessibility (DC6114 Only)
 UL Listed for ANSI/UL10B and UL10C,
 CAN/ULC S104 up to 3 Hours
 UL 228 UBC Standard 7-2 (1997) NFPA 252
 NFPA 80 National Fire Protection - Fire Door Assembly
 NFPA101 National Fire Protection - Life Safety
 ANSI/BHMA A156.18 Finishes

Description	Part Number	Standard Finish
Door Closer with Standard Arm, Power size 1-4, ADA, Less Cover	DC6114LCV	AL Aluminum Painted DU Duro/Dark Bronze Painted
Door Closer with Standard Arm, Power size 2-6, ADA, Less Cover	DC6126ICV	AL Aluminum Painted DU Duro/Dark Bronze Painted
Plastic slim Cover for DC61 Door Closer	DCCV61SLC	AL Aluminum Painted

For additional finish options not listed, contact Sales Department for MOQ and lead times

FEATURES

Aluminum Alloy Body

Closer bodies are cast of special aluminum alloy and machined to accommodate interactive steel components under operation conditions

Rack & Pinion Operation

Provides a smooth constant control of the door through its full opening and closing cycle. 180° door swing can be achieved when door, frame, and/or arm do not interfere

Non-Handed

DC6126/DC6114 door closer is non-handed and can be installed on either right or left hand swing doors

Sweep Speed Control Valve

Allows adjustment of door speed from the door's 90° open position down to approximately 10° from the closed position

Latch Speed Control Valve

Allows adjustment of door latch speed from approximately 10° down to the door's fully closed position

Tri-Packed

DC61 Series closers are packed with self-tapping (SRT), sex nuts & bolts (SNB) and parallel arm (PA) bracket to allow for regular, top jamb, and parallel arm installations

Adjustable Back-Check Valve

Provides control of the door in the opening cycle, beginning at approximately 75° of door opening. Back check cushions the door opening when the door is forcibly opened beyond its preadjusted setting

Multi-Sized Door Closer

Adjustable through the power range of 1 through 4, DC6114 Door Closer conforms to the opening force requirements of the ADA and ANSI/BHMA standard A117.1 for interior doors

OPTIONAL COVERS

DCCV61SLC

Plastic Slim Cover



PARALLEL ARM BRACKET

DCBK

Parallel Arm Bracket



FIXING PACKS

DCFP61

Standard fixing pack for closer body



DCFPBK

Standard fixing pack for parallel arm bracket



DCFPSNB

Standard sex nuts and bolts (SNB) fixing pack



CUTAWAY VIEW

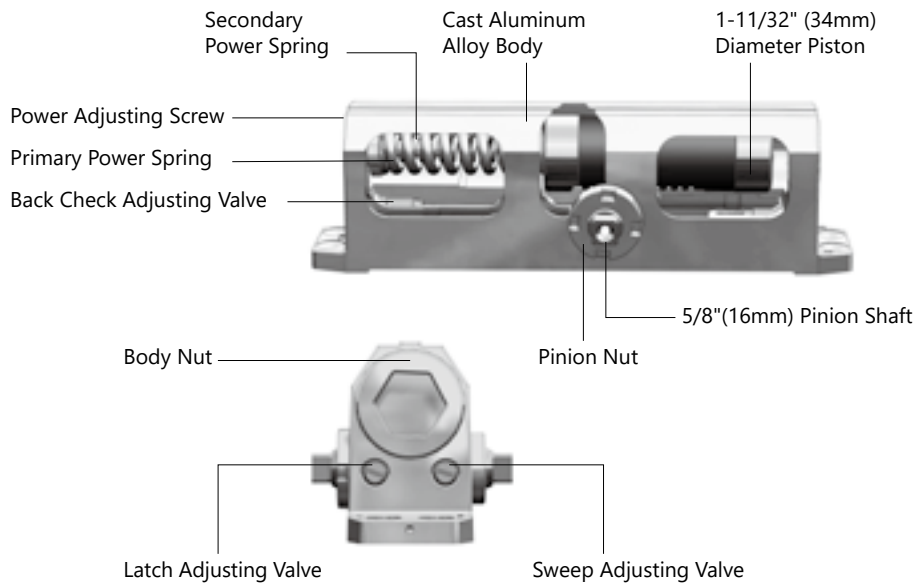

EXPLODED DIAGRAM

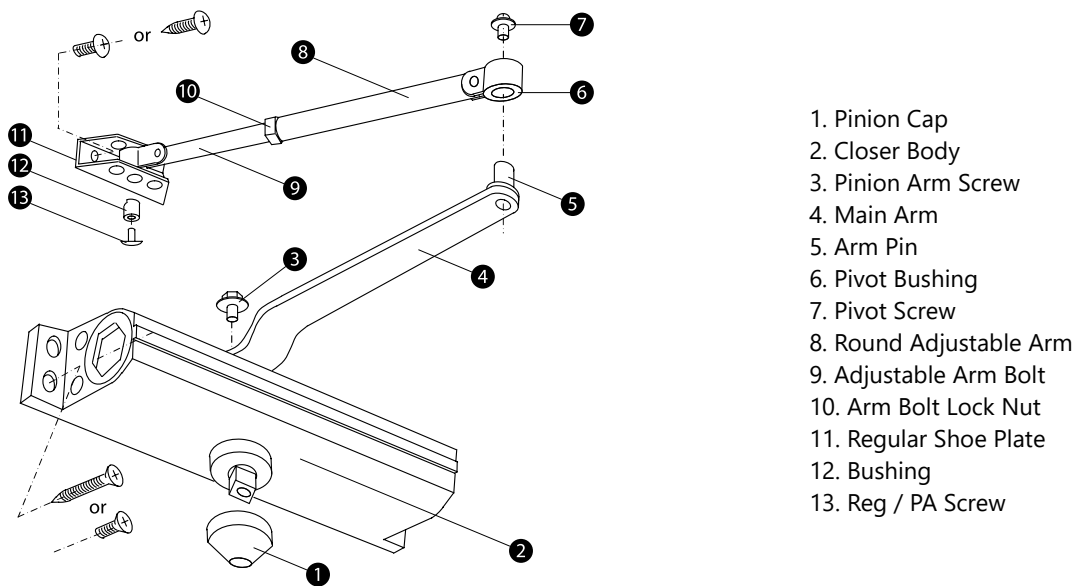

MOUNTING DIAGRAMS

Regular Mounting (Pull Side)

Regular arm is the most common and strongest mounting option. Usually the closer is mounted on the door and the arm is mounted on the frame

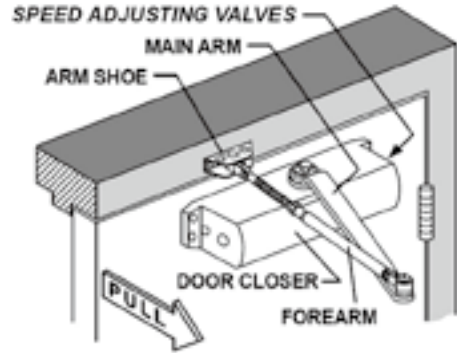
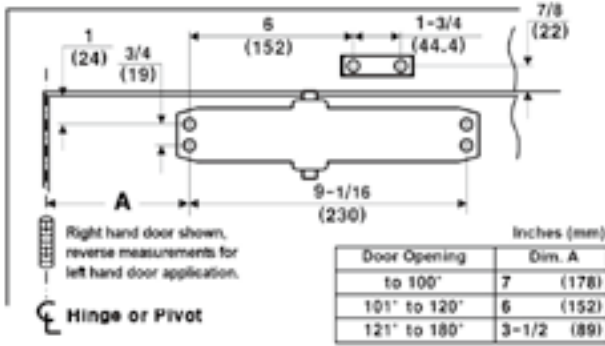

Top Jamb Mounting (Push Side)

Closer body is mounted to the frame with the arm straight out. Ideal for exterior door installations. You must consider frame depth reveal. Extended arm may be required

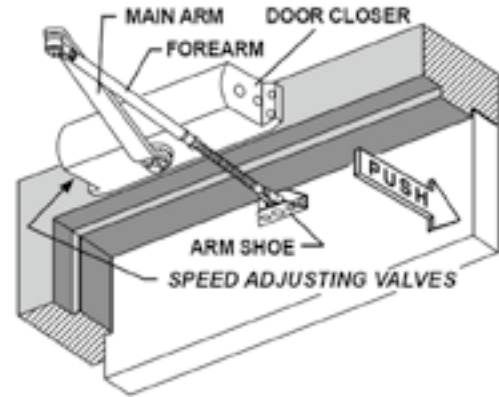
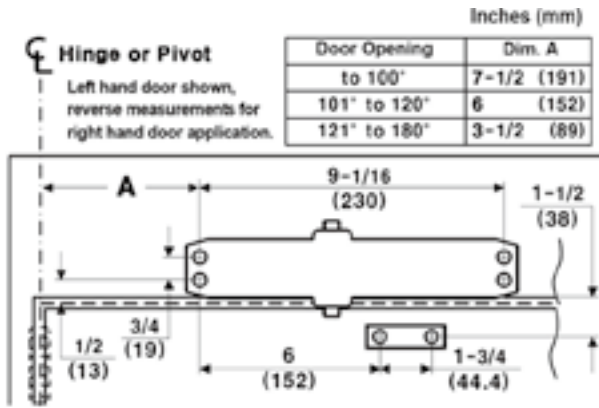

Parallel Arm Mounting (Push Side)

Closer body on door with parallel bracket on stop of frame. Arm is parallel to the door and does not stick out. Parallel arm installations have 25% less power than regular pull side mounting

