

PD8000, PD5000 MORTISE LOCKS with Flush Pulls for Pocket Doors



PD8000 with FH27 Linear Flush Pull



PD8000 with FH31 Regal Flush Pull



PD5000 with FH22 Luna Flush Pull



PD2000 TwistLock™ Edge-Pull Privacy Lock

FH17 BEZEL FLUSH PULL

PD8000/PD5000 for Sliding or Pocket Doors



SPECIFICATIONS

Standard Door Thickness	1-3/8" to 1-3/4" (35mm to 45mm) Thick Door Kits available
Backset	2-3/4" (70mm), 2-1/2" (63.5mm) and 2" (50.8mm)
Handing	Non-Handed
Thumbturn Spindle	5x5mm square
Deadbolt	1" (25.4mm) for 2-3/4" or 2-1/2" backset 3/4" (19mm) for 2" backset
Cylinder	Schlage C keyway 5 pin mortise cylinder with 2 keys (KD). Keying services available; order separately
Material	Stainless Steel/Brass

DIMENSIONS

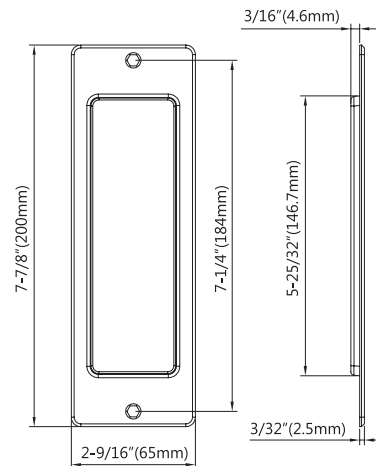

TRIM OPTIONS



FH1700
Flush Pull Only



FH1792
Flush Pull with TT09
Thumbturn



FH1704
Flush Pull with
Thumbturn Release



FH1703
Flush Pull with
Cylinder Hole

FH27 / FH27SL LINEAR FLUSH PULL

PD8000/PD5000 for Sliding or Pocket Doors



SPECIFICATIONS

Standard Door Thickness	1-3/4" (45mm) Thick Door Kits available
Backset	2-3/4" (70mm), 2-1/2" (63.5mm) and 2" (50.8mm)
Slim Trim	Slim Trim (FH27SL) available for 1-3/8" (35mm) doors
Handing	Non-Handed
Thumbturn Spindle	5x5mm square
Deadbolt	1" (25.4mm) for 2-3/4" or 2-1/2" backset 3/4" (19mm) for 2" backset
Cylinder	Schlage C keyway 5 pin mortise cylinder with 2 keys (KD). Keying services available; order separately
Material	Stainless Steel/Brass

DIMENSIONS

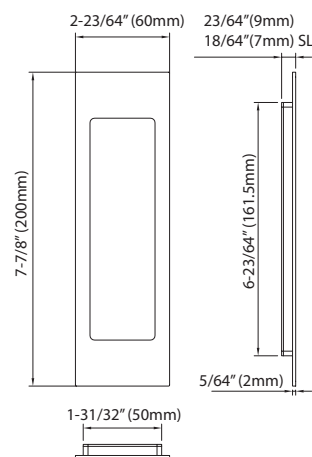

TRIM OPTIONS



FH2700 FH2700SL
Flush Pull Only



FH2792 FH2792SL
Flush Pull with TT09
Thumbturn



FH2704 FH2704SL
Flush Pull with
Thumbturn Release



FH2703*
Flush Pull with
Cylinder Hole



FH2782*
Flush Pull with
TT08 Thumbturn

* Not available with SL

FH29 ARC FLUSH PULL

PD8000/PD5000 for Sliding or Pocket Doors



SPECIFICATIONS

Standard Door Thickness	1-3/4" (45mm) Thick Door Kits available
Backset	2-3/4" (70mm), 2-1/2" (63.5mm) and 2" (50.8mm)
Handing	Non-Handed
Thumbturn Spindle	5x5mm square
Deadbolt	1" (25.4mm) for 2-3/4" or 2-1/2" backset 3/4" (19mm) for 2" backset
Cylinder	Schlage C keyway 5 pin mortise cylinder with 2 keys (KD). Keying services available; order separately
Material	Stainless Steel/Brass

DIMENSIONS

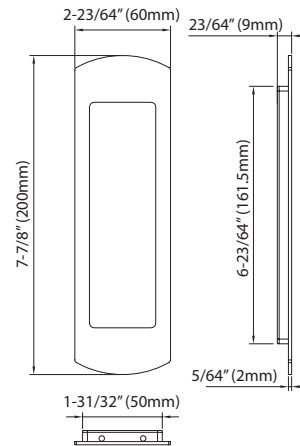

TRIM OPTIONS



FH2900
Flush Pull Only



FH2992
Flush Pull with TT09
Thumbturn



FH2904
Flush Pull with
Thumbturn Release



FH2903
Flush Pull with
Cylinder Hole



FH2982
Flush Pull with
TT08 Thumbturn

FH31 REGAL FLUSH PULL

PD8000/PD5000 for Sliding or Pocket Doors



SPECIFICATIONS

Standard Door Thickness	1-3/4" (45mm) Thick Door Kits available
Backset	2-3/4" (70mm), 2-1/2" (63.5mm) and 2" (50.8mm)
Handing	Non-Handed
Thumbturn Spindle	5x5mm square
Deadbolt	1" (25.4mm) for 2-3/4" or 2-1/2" backset 3/4" (19mm) for 2" backset
Cylinder	Schlage C keyway 5 pin mortise cylinder with 2 keys (KD). Keying services available; order separately
Material	Stainless Steel/Brass

DIMENSIONS

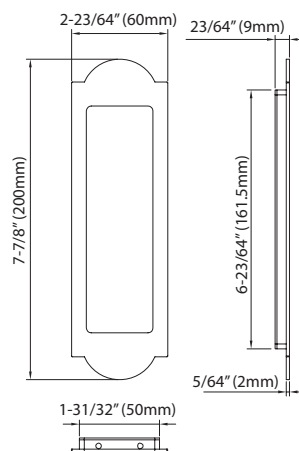

TRIM OPTIONS



FH3100
Flush Pull Only



FH3103
Flush Pull
with Cylinder Hole



FH3182
Flush Pull with
TT08 Thumbturn



FH3192
Flush Pull with
TT09 Thumbturn



FH3104
Flush Pull with
Thumbturn Release

FH32 CROWN FLUSH PULL

PD8000/PD5000 for Sliding or Pocket Doors



SPECIFICATIONS

Standard Door Thickness	1-3/4" (45mm) Thick Door Kits available
Backset	2-3/4" (70mm), 2-1/2" (63.5mm) and 2" (50.8mm)
Handing	Non-Handed
Thumbturn Spindle	5x5mm square
Deadbolt	1" (25.4mm) for 2-3/4" or 2-1/2" backset 3/4" (19mm) for 2" backset
Cylinder	Schlage C keyway 5 pin mortise cylinder with 2 keys (KD). Keying services available; order separately
Material	Stainless Steel/Brass

DIMENSIONS

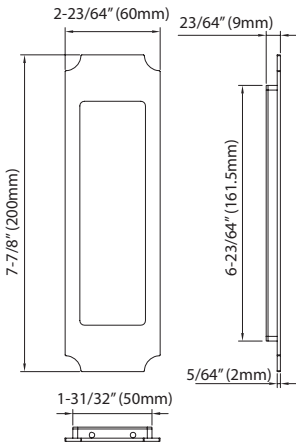

TRIM OPTIONS



FH3200
Flush Pull Only



FH3203
Flush Pull
with Cylinder Hole



FH3282
Flush Pull with
TT08 Thumbturn



FH3292
Flush Pull with
TT09 Thumbturn



FH3204
Flush Pull with
Thumbturn Release

FH22 LUNA FLUSH PULL

PD8000/PD5000 for Sliding or Pocket Doors



SPECIFICATIONS

Standard Door Thickness	1-3/4" (45mm) Thick Door Kits available
Backset	2-3/4" (70mm), 2-1/2" (63.5mm) and 2" (50.8mm)
Handing	Non-Handed
Thumbturn Spindle	5x5mm square
Deadbolt	1" (25.4mm) for 2-3/4" or 2-1/2" backset 3/4" (19mm) for 2" backset
Cylinder	Schlage C keyway 5 pin mortise cylinder with 2 keys (KD). Keying services available; order separately
Material	Stainless Steel/Brass

DIMENSIONS

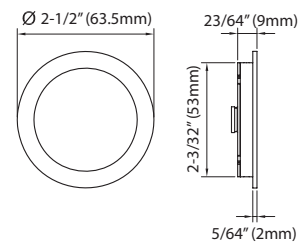

TRIM OPTIONS



FH2200
Flush Pull Only



FH2204
Flush Pull with
Thumbturn Release



FH2203*
Flush Pull with
Cylinder Hole

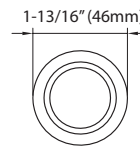

FH2282*
Flush Pull with
TT08 Thumbturn

* Not available with CF

FH22CF LUNA CONCEALED FIXING FLUSH PULL

PD8000/PD5000 for 1-3/8" or thicker Sliding or Pocket Doors



SPECIFICATIONS

Standard Door Thickness	1-3/8" (35mm) & 1-3/4" (45mm) Thick Door Kits available
Backset	2-3/4" (70mm), 2-1/2" (63.5mm) and 2" (50.8mm)
Handing	Non-Handed
Thumbturn Spindle	5x5mm square
Deadbolt	1" (25.4mm) for 2-3/4" or 2-1/2" backset 3/4" (19mm) for 2" backset
Material	Stainless Steel

DIMENSIONS

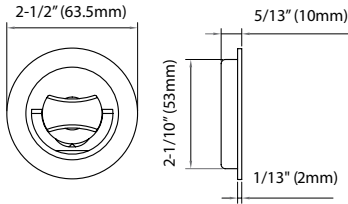

TRIM OPTIONS



FH2200CF
Flush Pull Only



FH2204CF
Flush Pull with
Thumbturn Release



FH2262CF
Flush Pull with
TT06 Thumbturn

FH23 URBAN FLUSH PULL

PD8000/PD5000 for Sliding or Pocket Doors



SPECIFICATIONS

Standard Door Thickness	1-3/4" (45mm) Thick Door Kits available
Backset	2-3/4" (70mm), 2-1/2" (63.5mm) and 2" (50.8mm)
Handing	Non-Handed
Thumbturn Spindle	5x5mm square
Deadbolt	1" (25.4mm) for 2-3/4" or 2-1/2" backset 3/4" (19mm) for 2" backset
Cylinder	Schlage C keyway 5 pin mortise cylinder with 2 keys (KD). Keying services available; order separately
Material	Stainless Steel/Brass

DIMENSIONS

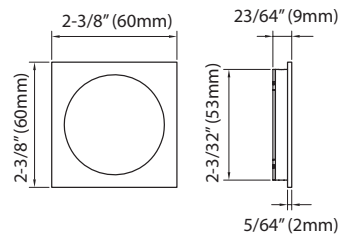

TRIM OPTIONS



FH3200
Flush Pull Only



FH3204
Flush Pull with
Thumbturn Release



FH3203*
Flush Pull with
Cylinder Hole

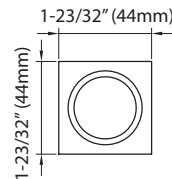

FH3282*
Flush Pull with
TT08 Thumbturn

* Not available with CF

FH23CF URBAN CONCEALED FIXING FLUSH PULLS

PD8000/PD5000 for 1-3/8" or thicker Sliding or Pocket Doors



SPECIFICATIONS

Standard Door Thickness	1-3/8" (35mm) & 1-3/4" (45mm) Thick Door Kits available
Backset	2-3/4" (70mm), 2-1/2" (63.5mm) and 2" (50.8mm)
Handing	Non-Handed
Thumbturn Spindle	5x5mm square
Deadbolt	1" (25.4mm) for 2-3/4" or 2-1/2" backset 3/4" (19mm) for 2" backset
Material	Stainless Steel

DIMENSIONS

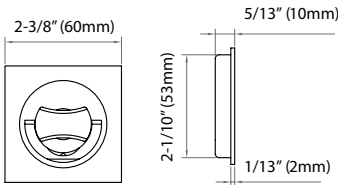

TRIM OPTIONS



FH2300
Flush Pull Only



FH2362CF
Flush Pull with
Thumbturn



FH2304CF
Flush Pull with
Thumbturn Release