

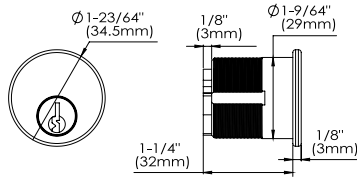

MORTISE CYLINDERS AND KEYS



Schlage C Keyway, 6 Pin, with Clover Cam, 2 Keys
 Standard Keyed Different (KD)
 Other Keying Services available
 All trims use 1-1/4" Mortise Cylinder for standard 1-3/4" door
 Other sizes or keyway cylinders available. Order separately

Illustration	Item Code	Description	Size	ANSI
<i>Mortise Cylinders</i>				
	CMB105	Mortise Cylinder, Schlage C Keyway, 5 pin, L Cam	1"	E09211
	CMB1186	Mortise Cylinder, Schlage C Keyway, 6 pin, L Cam	1-1/8"	E09211
	CMB1146	Mortise Cylinder, Schlage C Keyway, 6 pin, L Cam	1-1/4"	E09211
	CMB1386	Mortise Cylinder, Schlage C Keyway, 6 pin, L Cam	1-3/8"	E09211
	CMB1126	Mortise Cylinder, Schlage C Keyway, 6 pin, L Cam	1-1/2"	E09211
	CMB1346	Mortise Cylinder, Schlage C Keyway, 6 pin, L Cam	1-3/4"	E09211
<i>Dummy Cylinders</i>				
	CMB1140DM*	Mortise Dummy Cylinders, No Cam	1-1/4"	E09211

* Dummy function lockset does not include dummy cylinder. Dummy cylinder ordered separately if required

INTERCHANGEABLE CORE (IC) HOUSING WITH REMOVABLE MORTISE CAM

Solid Brass/ Small Format (SFIC) Housing
 Standard L Cam included for MC7000 Series mortise lock
 Accepts Best, Arrow and Falcon Cores

Illustration	Item Code	Description	Size	ANSI
	CMB1146-ICBA-HUS	SFIC Mortise Cylinder Housing, 6 Pin	1-1/4"	E09241
	CMB1386-ICBA-HUS	SFIC Mortise Cylinder Housing, 6 Pin	1-3/8"	E09241
	CMB1126-ICBA-HUS	SFIC Mortise Cylinder Housing, 6 Pin	1-1/2"	E09241
	CMB1586-ICBA-HUS	SFIC Mortise Cylinder Housing, 6 Pin	1-5/8"	E09241
	CMB1387-ICBA-HUS	SFIC Mortise Cylinder Housing, 7 Pin	1-3/8"	E09241
	CMB1127-ICBA-HUS	SFIC Mortise Cylinder Housing, 7 Pin	1-1/2"	E09241
	CMB1587-ICBA-HUS	SFIC Mortise Cylinder Housing, 7 Pin	1-5/8"	E09241

INTERCHANGEABLE CORES ONLY

Solid brass plug and housing / Small Format (SFIC) Core in Best A Keyway
 2 Change keys per Combined Core – A2 System Only
 1 master key or grand master key included per group/order

1 Control key per group/order
 6 or 7 pin cores replace Arrow, Best, Falcon
 Construction or Combined Core

Illustration	Item Code	Description	ANSI
	CMB-ICBA6-CST	SFIC Core Only, Best A Keyway, 6 Pin, Construction	E09251
	CMB-ICBA6-CMB	SFIC Core Only, Best A Keyway, 6 Pin, Combined	E09251
	CMB-ICBA7-CMB	SFIC Core Only, Best A Keyway, 7 Pin, Combined	E09251

MORTISE CYLINDERS AND KEYING

KEYS

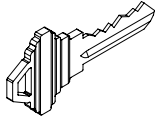
Illustration	Item Code	Description
	LSK-6SC-NP	Standard key Schlage C Keyway for 6 Pin, Nickel Plated
	LSK01-6SC-NS-DND	DND Nickel Silver Key, Schlage C Keyway for 6 Pin, w/"Do Not Duplicate"
	LSK06-BA-CRK	Extra Control Key for IC Core, Best A Keyway
	LSK06-BA-MK	Extra Master Key for IC Core, Best A Keyway
	LSK06-BA-GMK	Extra Grand Master Key for IC Core, Best A Keyway

KEYING SERVICES

Description	Item No.
Service: Key Cut including Key Blank	SV-KYCT
Service: Keyed Alike (KA)	SV-KA
Service: Keyed Alike Pair	SV-KA2
Service: Keyed Alike Group (Specify Number of Keyed Alike Per Group)	SV-KA (Number)
Service: Keyed to Specific Code	SV-KS
Service: Master Keying	SV-MK
Service: Grand Master Keying with 2 or more Master groups.	SV-GMK
Service: Construction Master Keying Service	SV-CMK
Service: Great Grand Master Key	SV-GGMK

Description	Item No.
Service: IC Core Key Cut including Key Blank	SV-ICKYCT
Service: IC Core Keyed Alike (KA) - Each cylinder in the group is keyed alike	SV-ICKA
Service: IC Core Keyed to Specific Code - Cylinder is keyed to a specific code	SV-ICKS
Service: IC Core Master Keying - 2 Change Keys per Cylinder and 3 Master Keys per MK	SV-ICMK
Service: IC Core Grand Master Keying (2 or more MK groups included)	SV-ICGMK
Service: IC Core Master Keying, 2 Change Keys Per Cyl, and 3 Master Keys per MK Group	SV-ICMK

Description	Item No.
Service: Euro Cylinder Key Cut including Key Blank	SV-CYKYCT
Service: Euro Cylinder Keyed Alike (KA) - Each cylinder in the group is keyed alike	SV-CYKA
Service: Euro Cylinder Keyed to Specific Code - Cylinder is keyed to a specific code	SV-CYKS
Service: Euro Cylinder Master Keying - 2 Change Keys per Cylinder and 3 Master Keys per	SV-CYMK
Service: Euro Cylinder Grand Master Keying (2 or more MK groups included)	SV-CYGMK
Service: Euro Cylinder Master Keying, 2 Change Keys Per Cyl, and 3 Master Keys per MK	SV-CYMK