

BL CYLINDRICAL LOCKSETS

Commercial Grade 2

SPECIFICATIONS

Door Thickness 1-1/2" (38mm) ~ 2" (51mm) standard doors

Door Prep Standard 161 prep. w/optional thru-bolts
Crossbore 2-1/8" (54mm)
Edgebore 1" (25mm),
Latch face 1-1/8" (28.6mm) x 2-1/4" (57mm)

Backset 2-3/4" (70mm) standard
2-3/8" (60mm) optional

Cylinder 6-pin anti-pick tumbler, solid brass cylinder

Keys Two (2) keys per lock. Schlage C keyway
Keyed-Different standard
Keyed-Alike, Construction key, Master key suite,
or other keyway available by special order

Handing Non-handed

Trim Solid zinc diecast levers
55° lever rotation for full latch retraction

Clutch Function (CL) Outside lever free wheeling while
locked to prevent vandalism

Rose 3-3/8" (86mm) diameter. Brass roses with
concealed screws
Threaded interior and exterior roses
Removable thru bolts

Latchbolt 1/2" (12.7mm) throw,
Stainless Steel 3 hour fire-rated latchbolt
Reversible for flat and beveled doors

Faceplate 1-1/8" (28.6mm) x 2-1/4" (57mm) square
corner standard. Stainless Steel or brass
faceplate

Strike ANSI curved lip strike 4-7/8" (124mm) x
1-1/4" (32mm) x 1-1/4" (32mm) lip to center
standard. Full lip strike or T strike available

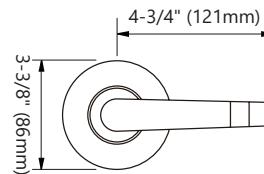

07 Lever

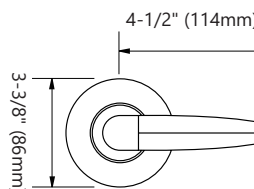
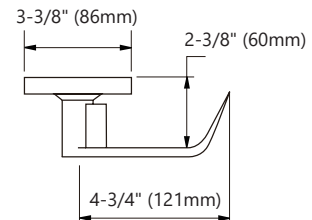

09 Lever

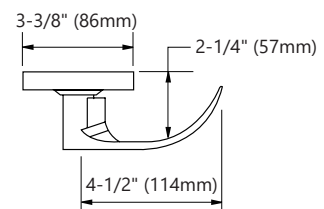

STANDARD FINISHES

- 10B Oil Rubbed Bronze
- 19G Graphite Black
- 26D Satin Chrome
- 26 Polished Chrome

For additional finish options not listed, contact Sales Department for MOQ and lead times

CODE COMPLIANCE



ANSI A156.2 Grade 1, UL 10C and UBC 7.2 for positive pressure
ANSI A117.1 ADA Barrier-free Accessibility
C-UBC California Uniform Builders Code-2001
NFPA-80 National Fire Protection-1999
NFPA-101 National Fire Protection-Life Safety-2000

BL LEVER DESIGNS



07 IN STOCK

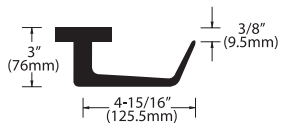

09 IN STOCK

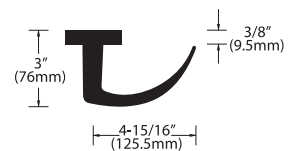

BL FUNCTIONS

Non Keyed Locks

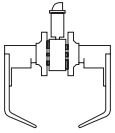

10 (ANSI: F75)

Passage Latch

Both levers are always unlocked from inside and outside

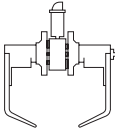

40 (ANSI: F76)

Privacy Lock

Outside lever is locked by push button inside
 Outside lever is unlocked by outside emergency release, rotating inside lever or closing door

Inside lever is always free for emergency exit

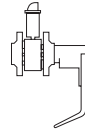

25 (ANSI: F111)

Exit/Communicating Lock

Inside lever is always unlocked
 Blank plate outside
 Inside lever is always free for emergency exit

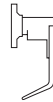

17

Single Dummy Trim

Single dummy trim for one side

Keyed Locks

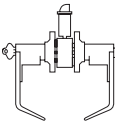

53 (ANSI: F109)

Entrance Lock

Push and turn button to keep outside lever locked. Key is always required to unlock the outside lever until button is reset
 Push button only locks outside lever until it is unlocked by key or by turning inside lever
 Key releases outside lever and push button inside, except when inside button is pushed and turned to keep outside lever locked
 Inside lever always free for emergency exit

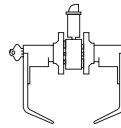

70 (ANSI: F84)

Classroom Lock

The outside lever is locked or unlocked by key
 When unlocked the lockset works as a passage set
 When locked, key required from outside to unlock the lockset
 The inside lever is always unlocked for emergency exit

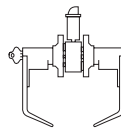

80 (ANSI: F86)

Storeroom Lock

Outside lever is unlocked only while key is turned
 Inside lever is always free for emergency exit

For additional finish options not listed, contact Sales Department for MOQ and lead times

BL DEAD LATCHES AND SPRING LATCHES



LSL01N
2-3/8" Spring Latch
1-1/8" Faceplate



LSL01K
2-3/8" Dead Latch
1-1/8" Faceplate



LSL02N
2-3/4" Spring Latch
1-1/8" Faceplate



LSL02K
2-3/4" Dead Latch
1-1/8" Faceplate

HOW TO ORDER

Stocked Grade 2 BL Cylindrical Locksets

For leversets using the same interior and exterior lever and finish combination: Stock items have shorter lead times.

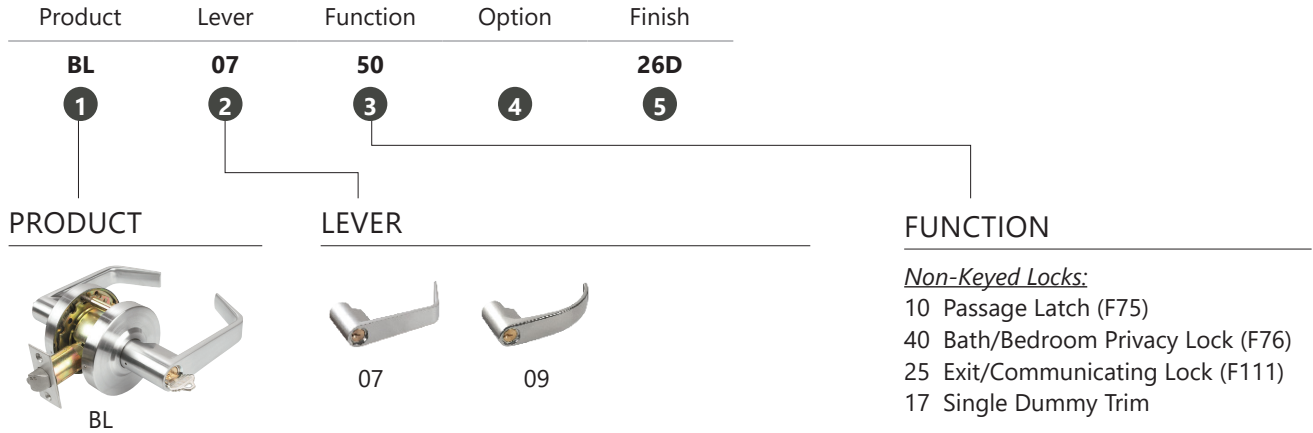

④ OPTION

- Blank Non-clutch
- CL Clutch (BL Series Only)

⑤ FINISH

