

# TUBULAR HANDLESETS



## SPECIFICATIONS

<b>Door Thickness</b>	1-3/4" (44mm) standard Thick Door Kits available
<b>Backset</b>	2-3/8" (60mm) standard 2-3/4" (70mm) optional
<b>Handing</b>	Handing specification required Latchbolt is field reversible
<b>Center Distance</b>	Lever to Cylinder 5-1/2" (140mm)
<b>Cylinder &amp; Keys</b>	5-pin Schlage C keyway with 2 keys
<b>Leverset Thru-bolts</b>	2 EA M4x35mm
<b>Deadbolt Thru-bolts</b>	2 EA M5x50mm

## STANDARD FINISHES

- 32D Satin Stainless Steel
- 32 Bright Stainless Steel
- 10B Oil Rubbed Bronze (Limited Styles available)
- 19G Graphite Black (Limited Styles available)
- PVD4 Satin Brass (Limited Styles available)
- SP Split Finish (Limited Styles available)
- CeraMax Ceramic Coating: C19G Graphite Black, C19 Flat Black, CGY Stormy Grey, CDB Dark Bronze

*For additional finish options not listed, contact Sales Department for MOQ and lead times*

## FUNCTION

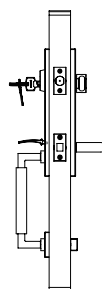

### Entrance (C563/C573)

Deadbolt is locked or unlocked by key outside or thumbturn inside. Thumb-piece from outside or lever from inside retracts latchbolt. Deadbolt and latch are not interconnected.

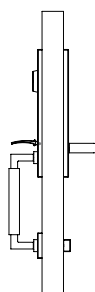

### Entry Dummy (TDP)

NY/ MH trim with rim dummy cylinder outside, dummy plate escutcheon inside.

## ENTRANCE HANDLESETS

### LEVER DESIGNS AND FINISHES (FOR INSIDE HANDLESET)



**101 Cologne**  
(32, 32D)



**103 Oslo**  
(32, 32D)



**104 Brussels**  
(32, 32D)



**105 Frankfurt**  
(32, 32D, 19G, 10B)



**106 Copenhagen**  
(32, 32D, 10B)



**107 Stockholm**  
(32, 32D)



**108 Vienna**  
(SP\*, PVD4)



**210 Air-stream**  
(32, 32D, 10B)



**211 Breeze**  
(32, 32D, 10B)

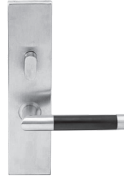

**213 Cabernet**  
(32, 32D)



**214 Champagne**  
(32, 32D, 10B)



**217 Horizon**  
(32, 32D)



**221 Aurora**  
(32, 32D, SP, 19G, 10B)



**223 Phoenix**  
(32D, SP\*)



**225 Waterfall**  
(32, 32D)



**226 Summer**  
(32, 32D)



**227 Stratus**  
(32, 32D)



**243 Sunrise**  
(32, 32D, 10B, 19G, PVD4)



**251 Sequoia**  
(32, 32D, SP\*)



**276 Plaza**  
(32, 32D, 19G, PVD4)



**300 Napa**  
(32, 32D, 19G)



**311 Crest**  
(32, 32D, 10B)



**318 Café**  
(32, 32D, 19G, 10B)



**319 Hampton**  
(32, 32D, 19G)

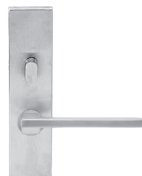

**320 Empire**  
(32, 32D, 19G)



**344 Ecco**  
(32, 32D)



**345 Tokyo**  
(32, 32D, 19G, 10B)



**351 Toronto**  
(32, 32D)

#### Lever Designs with "Return To Door" (RTD)

Compliant with California Fire Code



**379 Arctic**  
(32, 32D)



**380 Polaris**  
(32, 32D)



**102 Munich**  
(32, 32D)



**109 Stuttgart**  
(32, 32D)



**244 Twilight**  
(32, 32D)



**321 Valencia**  
(32, 32D, 19G)



**346 Osaka**  
(32, 32D)

\*SP is a two-tone stainless steel finish: satin (32D) finish on lever grip, polished (32) finish on lever neck and roses.

## ENTRANCE HANDLESETS

### TUBULAR LATCH

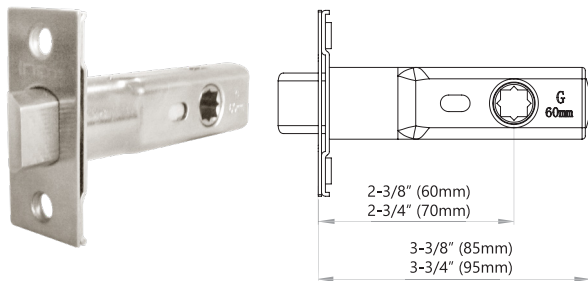

TL5 – Residential Grade  
 28° Degree Latch Retraction  
 Backset: 2-3/8" (60mm), 2-3/4" (70mm)  
 Function: Passage (For Tubular Handlesets Only)  
 Faceplate: 1" x 2-1/4"

Backset	Function	Item Code
2-3/8" (60mm)	Passage	<b>TL561</b>
2-3/4" (70mm)	Passage	<b>TL571</b>

### STRIKES

All latches come with both T-Strike and Full-lip Strike with square corners. Full-lip Strike with Radius Corner and ASA Strike can be ordered separately.

Full-lip Strike  
**LSR-D1**  
 1-3/4"x2-1/4"

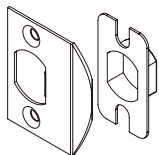

Full-lip Strike 1/4" Corner  
**LSR-D14**  
 1-3/4"x2-1/4"

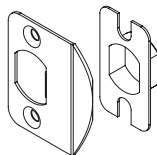

T- Strike  
**LSR-T1**  
 1-1/8" x 2-3/4"  
 w/lip 1-1/2"x1/2"

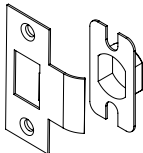

ASA Strike (ANSI Standard)  
**LSR-ASA**  
 1-1/4"x4-7/8"

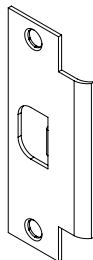

### CHANGE LATCH BOLT DIRECTION FOR TL5 LATCH

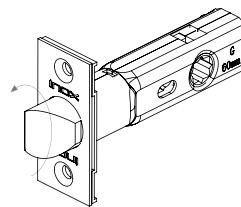

Change the latch direction 180° with the faceplate together.

Note: Be sure to install the latch with faceplate attached to the latch body

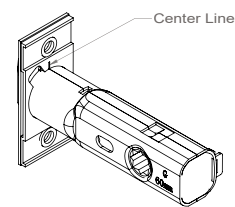

Note: Please ensure the center line on the back of the faceplate meets the center seam of the latch case

### GEAR DRIVE

Slim Gear Drive design fits perfectly in INOX Entrance Handleset Escutcheons

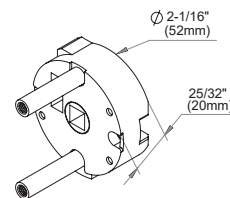

### SPINDLE FOR TUBULAR LATCH TL5 AND GEAR DRIVE

**FC-SW8875**

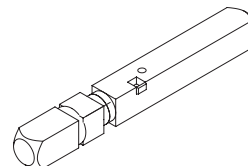

## DEADBOLT

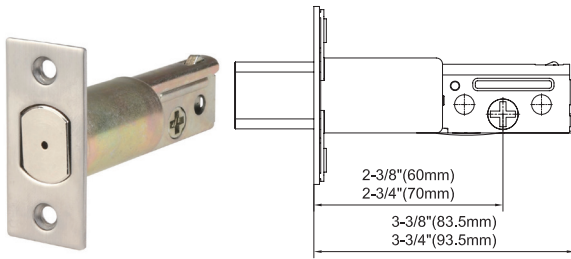

<b>Backset</b>	2-3/8" (60mm), 2-3/4" (70mm)
<b>Deadbolt</b>	1" (25mm) throw with anti-drill pin
<b>Function</b>	Suitable for entry door or doors needing to be locked
<b>Faceplate</b>	2-1/4" x 1"
<b>Cylinder &amp; Keys</b>	5-pin Schlage C keyway cylinder with 2 keys

Backset	Item No.
2-3/8"	<b>BT160</b>
2-3/4"	<b>BT170</b>
3 Hour Fire-Rated	
2-3/8"	<b>BT160F</b>
2-3/4"	<b>BT170F</b>

## DEADBOLT STRIKE AND FACEPLATE

Deadbolt Faceplate

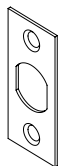

**BT1-FSP**

Deadbolt Strike w/ reinforcement plate and dustbox

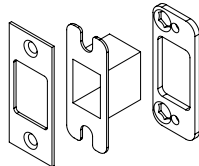

**LSR-BT1**

## RIM CYLINDERS

Schlage C Keyway, 5 Pin, with Tailpiece, 2 Keys.  
Standard Keyed Different (KD).  
Other Keying Services Available.

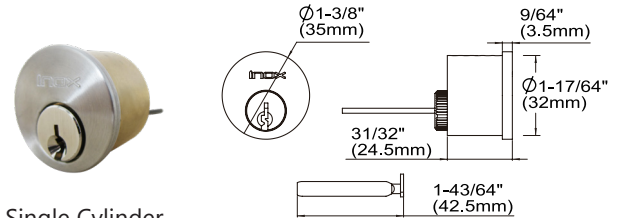

Single Cylinder  
**CRB105**

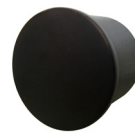

Dummy Cylinder  
**CRA10D**



Thumbturn  
**TT04C**

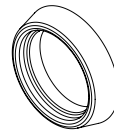

Cylinder Escutcheon  
**EC-R460COL**