



PD97ES

Electrified Mortise Locks with Auto-locking & Monitoring for Sliding Doors

- Motor Driven 12/24V electrified lock for sliding doors
- Built-in DPS & DBM sensors, enabling auto-latching and auto-locking functions
- Supports touchless opening solutions when paired with an auto-operator
- Fail Secure lock remains mechanically locked during power failure, ensuring security
- Designed for easy integration with access control and monitoring systems

SPECIFICATIONS

Door Thickness	1-3/4" (45mm) Standard
	1-3/8" (35mm) Thin Door Kit available for XGT only
	2" to 2-1/4" (50mm to 57mm) Thick Door Kit available
Backset	2-3/4" (70mm)
	2-1/2" (63.5mm)
Lever Spindle	8 x 8mm square
Thumbturn Spindle	5 x 5mm square
Center to Center Distance	Lever to Cylinder: 3-7/8" (98mm)
	Lever to Thumbturn: 2-11/16" (68mm)
Handing	Specify handing when ordering
Cylinder	Schlage C keyway 6 pin, 1-1/4" mortise cylinder with 2 keys (standard). Optional SFIC and LFIC housing and cores available
CAM	CAM01-SCL Clover Cam
Material	Trim: Stainless Steel
	Lockcase: Heavy gauge Steel
	Bolt: Brass and Stainless Steel
	Faceplate/Strike: Stainless Steel
	Cylinder: Solid Brass

ELECTRICAL SPECIFICATIONS

Maximum current for individual parts when in operation at 12/24V:

Lock Body	560 mA
Strike	40 mA
Keypad	90mA
Handwave	30 mA
Relay	30 mA
Monitor	30 mA



CODE COMPLIANCE

- UL1034 Burglary-Resistant Electric Locking Mechanisms
- UL294 Standard for Access Control System Units
- ANSI/BHMA A156.25 Electrified Mortise Locks
- ANSI/BHMA A156.18 Finishes
- ANSI A117.1 ADA Accessibility

FINISH

- Satin Stainless Steel -32D, Bright Stainless Steel -32, Satin Brass - PVD4 (on selective lever designs)
- CeraMax Ceramic Coating - C19G Graphite Black, C19 Flat Black, CGY Stormy Grey, CDB Dark Bronze
- Please see Finish Solutions on INOX Website for special order finishes

FUNCTION

PD97ES Functions are **Fail Secure**. Deadbolt auto-locks once door is closed; during power failure, deadbolt remains mechanically locked from outside.

PD97ES includes the following monitoring sensors:

- REX = Request-to-Exit Monitoring Switch
- DBM = Deadbolt Monitoring Switch
- DPS = Door Position Switch

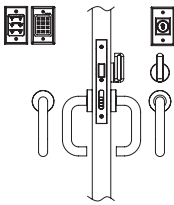

Patio/Exit: PD97ES60

- Deadbolt projected/retracted by built-in stepper motor when energized by 12/24V DC power transferred through contacts on lock and strike
- Thumbturn inside throws/retracts deadbolt to lock/unlock door
- Outside lever is rigid at all times
- Inside lever always unlocks deadbolt for emergency egress

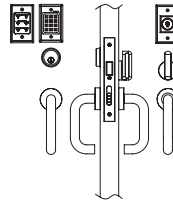

Entry/Office: PD97ES53

- Latchbolt projected/retracted by built-in stepper motor when energized by 12/24V DC power transferred through contacts on lock and strike
- Key from outside to throw/retract latchbolt to lock/unlock door
- Thumbturn inside throws/retracts latchbolt to lock/unlock door
- Outside lever is rigid at all times
- Inside lever always unlocks latchbolt for emergency egress

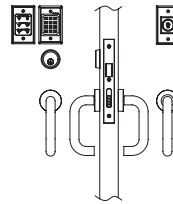

Storeroom: PD97ES80

- Latchbolt projected/retracted by built-in stepper motor when energized by 12/24V DC power transferred through contacts on lock and strike
- Key from outside to throw/retract latchbolt to lock/unlock door
- Door cannot be locked from inside
- Outside lever is rigid at all times
- Inside lever always unlocks latchbolt for emergency egress

FUNCTION TABLE

	Entry / Office	Storeroom	Patio/Exit
Outside Lever	×	×	×
Inside Lever	×	×	×
Lockcase	×	×	×
Cylinder	×	×	
Inside Thumbturn	×		×
Optional Accessories			
Power Supply	×	×	×
Monitoring Panel	×	×	×
Keypad w/Built-in Relay	×	×	×
Push Button	×	×	×
Handwave	×	×	×

PD97ES ELECTRIFIED SLIDING DOOR MORTISE LOCK

COMPONENTS

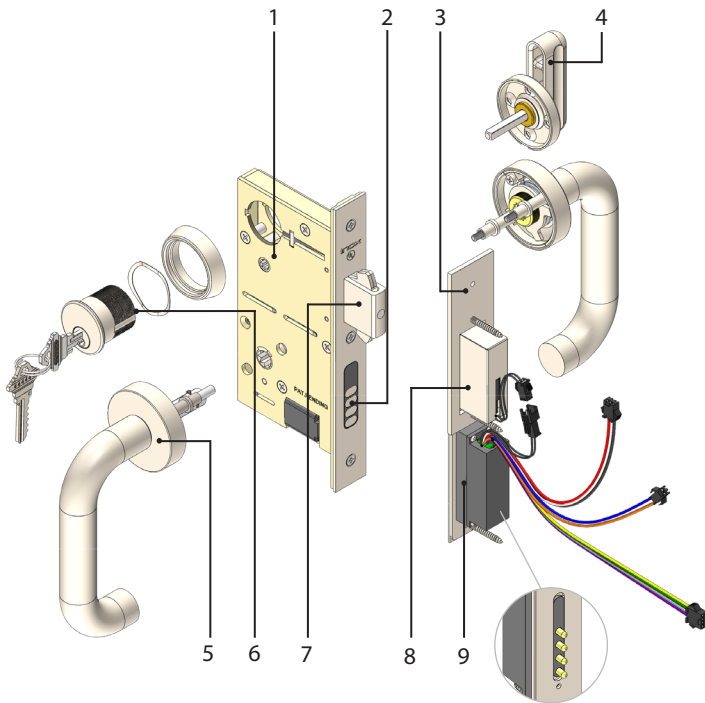

Description

- 1 PD97ES lockcase and faceplate; 2-3/4" backset **PD97ES-234** or 2-1/2" backset **PD97ES-212**
- 2 Faceplate contacts; Auto-locking, DPS (Door Positioning Switches), Power Transfer
- 3 Strike with reinforcement plate for door frame
- 4 **TT07-ADA** ADA Compliant thumbturn
- 5 Heavy-duty Stainless Steel cast rose with choice of X Series lever design
- 6 Schlage C keyway, 6 pin 1-1/4" mortise cylinder **CMB1146**
- 7 1" (25.4mm) heavy-duty brass bolt throw with self-retracting non-marring hooks
- 8 Dust box with DBM (Deadbolt Monitoring Sensor)
- 9 Power Transfer Strike with spring-loaded prongs **PD97ES-ADJ-STRK** 6-9/16"x1"x3/16"

Optional INOX Access Control Accessories

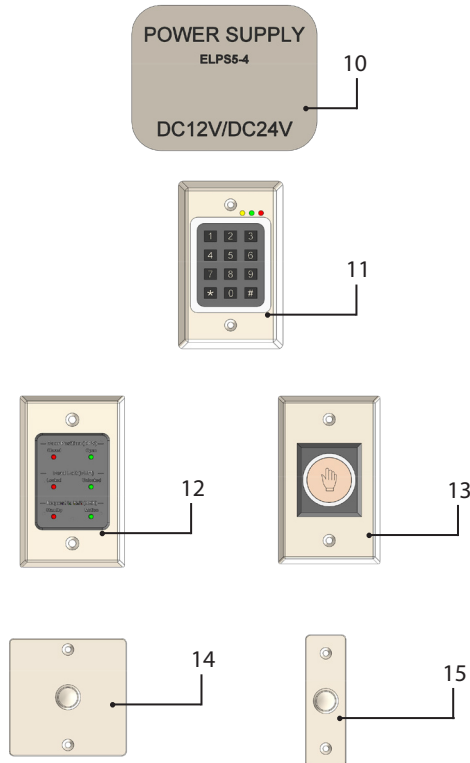

Optional Accessories, use the part numbers below as new line items.

- 10 **ELPS5-4** Power Supply with built-in surge protection, Voltage: 2A@12/24V DC, Dimension: 11"x11"x4"
- 11 **AC-KP1200** Stainless Steel keypad faceplate for indoor electrically locked door application, Voltage: 12/24V DC, Dimension: 4-1/2 x2-3/4"x1-1/4"
- 12 **AC-MP100** Stainless Steel Monitoring Panel Dimension: 4-1/2"x2-3/4"x3/4"
- 13 **AC-IR1100** Handwave sensor with illuminated display, Voltage: 2A@12/24V DC, Dimension: 4-1/2"x2-3/4"x1"
- 14 **AC-PB200** Wide Push Button with illuminated display, Dimension: 3-3/8"x3-3/8"x3/4"
- 15 **AC-PB100** Narrow Push Button with no illuminated display, Dimension: 3-1/2"x1-1/8"x1"

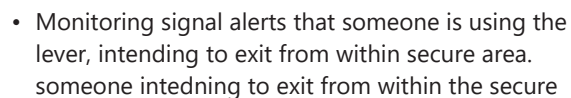

PD97ES ELECTRIFIED SLIDING DOOR MORTISE LOCK

WIRING DIAGRAM

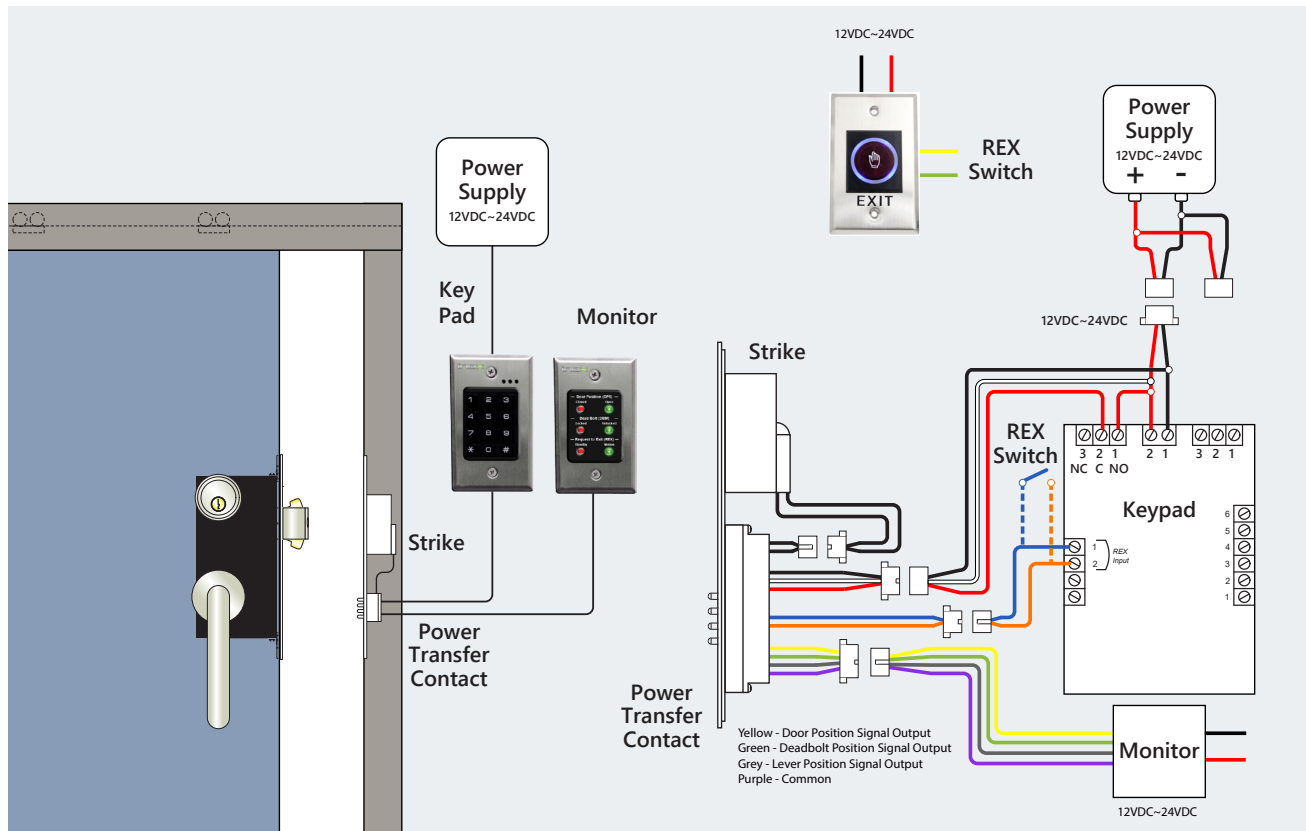

This product for UL compliance shall be used with UL Listed access control and burglar alarm control panels / peripheral devices. Accessories are shown for reference only and not evaluated for UL294 or UL1034.

PD97ES Electrified Locks are designed to operate at 12/24V. Complete INOX system maximum current draw is 780 mA. INOX breakdown of individual items:

Lock Body	560mA
Strike	40 mA
Keypad	90 mA
Handwave	30 mA
Relay	30 mA
Monitor	30 mA

For UL compliance the product is to be powered via a UL294 or UL603 or UL2610 power supply with a class 2 power limited output suitable for the power requirement of the product.

Door Position Switch (DPS), Deadbolt Monitoring Switch (DBM): 250K cycles of operation resistive load.

TRIM AND THUMBTURN OPTIONS

ROSE & LEVER DESIGN



XGT Rose



XGS Rose

*Return-to-Door Lever Designs comply with California and other state building codes for door openings



201 COLOGNE



202 MUNICH*



205 FRANKFURT



221 AURORA



243 SUNRISE



244 TWILIGHT*



276 PLAZA



318 CAFE



319 HAMPTON



320 EMPIRE



345 TOKYO



346 OSAKA*

THUMBTURN OPTIONS

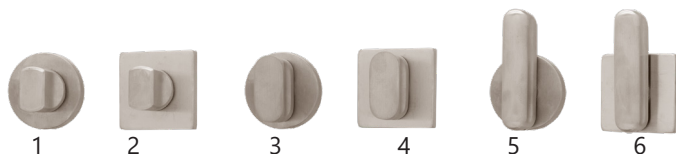

Ref.	Description	Part Number
1	TT02 Thumbturn in Round Rosette	EC-R460TT02
2	TT02 Thumbturn in Square Rosette	EC-S420TT02
3	TT04 Thumbturn in Round Rosette	EC-R460TT04
4	TT04 Thumbturn in Square Rosette	EC-S420TT04
5	ADA TT07 Thumbturn in Round Rosette	EC-R460TT07-ADA
6	ADA TT07 Thumbturn in Square Rosette	EC-S420TT07-ADA

PD97ES ELECTRIFIED SLIDING DOOR MORTISE LOCK

ELECTRIFIED LOCKS COMPARISON

Trim	PD97	PD97PT	PD97PT-ATL	PD97ES
X Series Trim	x	x	x	x
Outside Surface Pull with Inside Lever for Egress	x	x	x	x
Performance Capabilities				
Touchless Unlocking	x	x	x	x
Built-in Power Transfer within Lockset		x	x	x
Self-latching/Auto-latching *			x	x
Auto-locking with Monitoring Panel				x
Compliance Certification				
UL294 Safety and Security for Access Control System		x	x	x
UL1784 Air Leakage Test for Draft, Smoke Door Assembly			x	x
UL1034 Burglary Resistant Electric Lock Mechanism	x	x	x	x
ANSI/BHMA A156.25 Electrified Locking Device	x	x	x	x

* Office Function only



HOW TO ORDER A MORTISE LOCK FOR SLIDING DOOR

HOW TO ORDER LOCKSETS

Use the sequence below to order mortise locksets specification. Please see price book for parts or additional service upcharge.

Rose	Lever	Lock	Function	Backset	Cylinder	Thumbturn	Finish	Handing
XGT	243	-PD97ES	53	A	CMB1146	GT04	32D	LH
1	2	3	4	5	6	7	8	9

ROSE



XGT XGS

LEVER

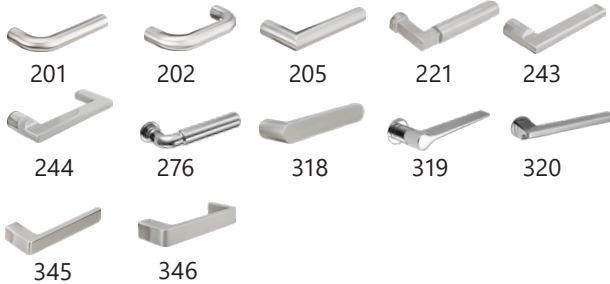

LOCK

PD97ES

FUNCTION

53 Entrance
60 Patio
80 Storeroom

5 BACKSET

Backset Blank = 2-3/4"

Backset A = 2-1/2"

6 CYLINDER



CMB1146

1-1/4" Cylinder, 6 pin

EC-R460COL Round Collar
EC-S420COL Square Collar

CMB1186

1-1/8" Cylinder 6 Pin

No Collar Required

CMB1386

1-3/8" Cylinder, 6 pin

EC-R417COL Round Collar
EC-S420COL + EC-R456COL Square Collar



CMB1146-ICBA-HUS

1-1/4" SFIC housing, 6 pin

EC-R460COL Round Collar
EC-S420COL Square Collar



CMB1387-ICBA-HUS

1-3/8" SFIC housing, 7 pin

EC-R417COL Round Collar
EC-S420COL + EC-R456COL Square Collar

CMB112-LFIC-HUS

1-1/2" LFIC housing, 6 pin

EC-R417COL Round Collar
EC-S420COL + EC-R456COL Square Collar

7 THUMBTURN



GT02

GT04

GT07

GS02

GS04

GS07

8 FINISH

Standard:



32D



C19G



C19



CGY

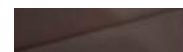

CDB



32



PVD4

9 HANDING

RH = Right Hand

LH = Left Hand

