

ANSI/BHMA GRADE 1 & GRADE 2 Cylindrical Locksets

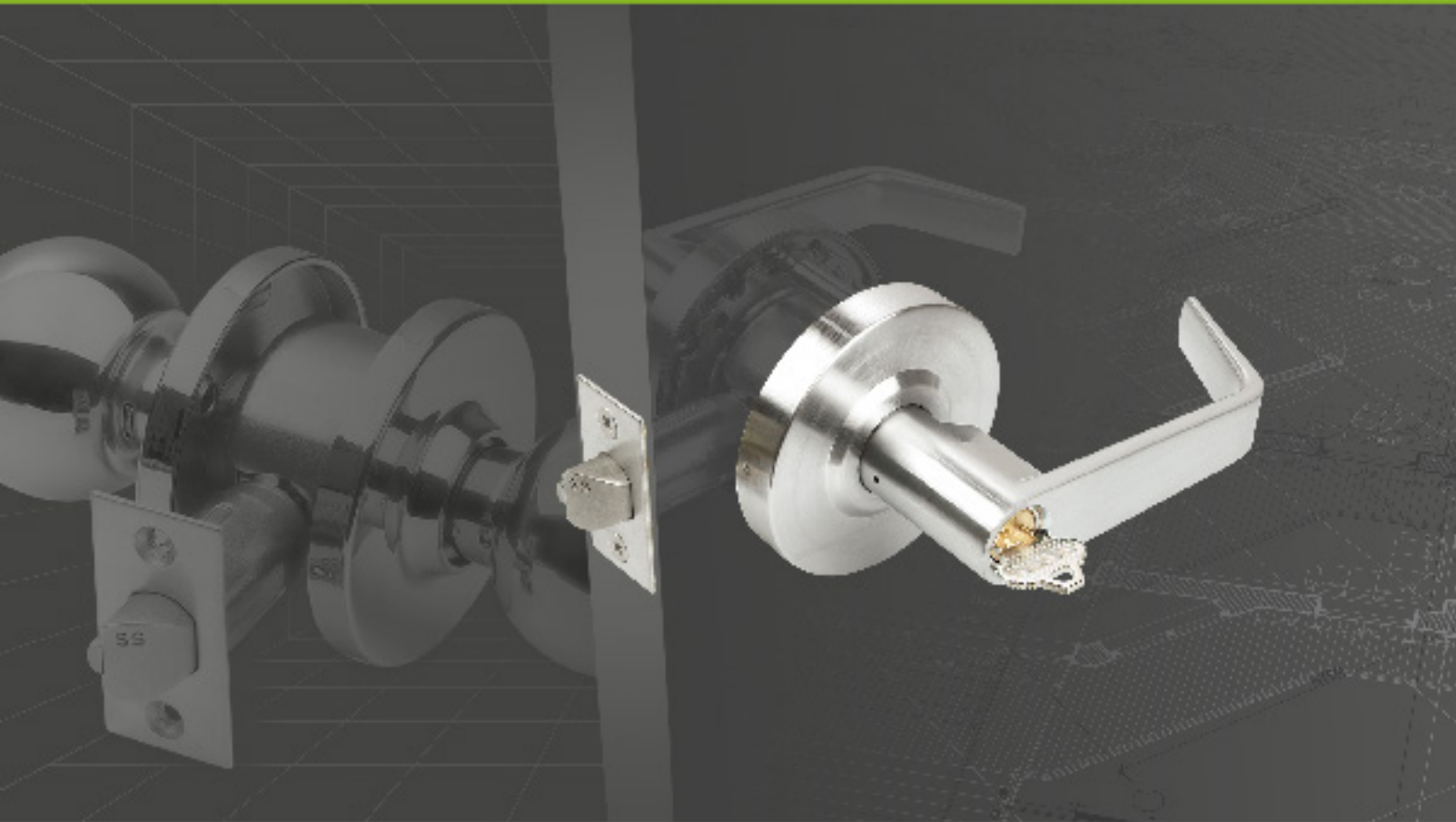

CL Cylindrical Locksets

BL Cylindrical Locksets

CX/BX Deadbolts

CONTENTS



Grade 1 CL Cylindrical Locksets

- Page 01** CL Cylindrical Locksets
 - Page 03** CL Lever Designs
 - Page 04** CL Functions
 - Page 05** CL Dead Latches and Spring Latches
 - Page 06** How to Order
-



Grade 2 BL Cylindrical Locksets

- Page 07** BL Cylindrical Locksets
 - Page 09** BL Lever Designs
 - Page 10** BL Functions
 - Page 11** BL Dead Latches and Spring Latches
 - Page 12** How to Order
-



Grade 1 CX/Grade 2 BX Deadbolts

- Page 13** CX Deadbolt
 - Page 14** CX Heavy Duty Deadbolt
 - Page 15** BX Deadbolt
 - Page 16** BX Standard Duty Deadbolt
 - Page 17** CX/BX Functions
 - Page 18** How to Order
-

- Page 19** Parts and Services
- Page 22** Cross References

Disclaimer: All information in this catalog has been deemed accurate as of the date of printing. We are continuously improving and expanding our line in an effort to offer our clients the finest quality products and services; therefore, Unison Hardware, Inc., reserves the right to alter this information or correct printing errors at any time.

©2025 Unison Hardware, Inc. All Rights Reserved.V20250131

CL CYLINDRICAL LOCKSETS

Commercial Grade 1

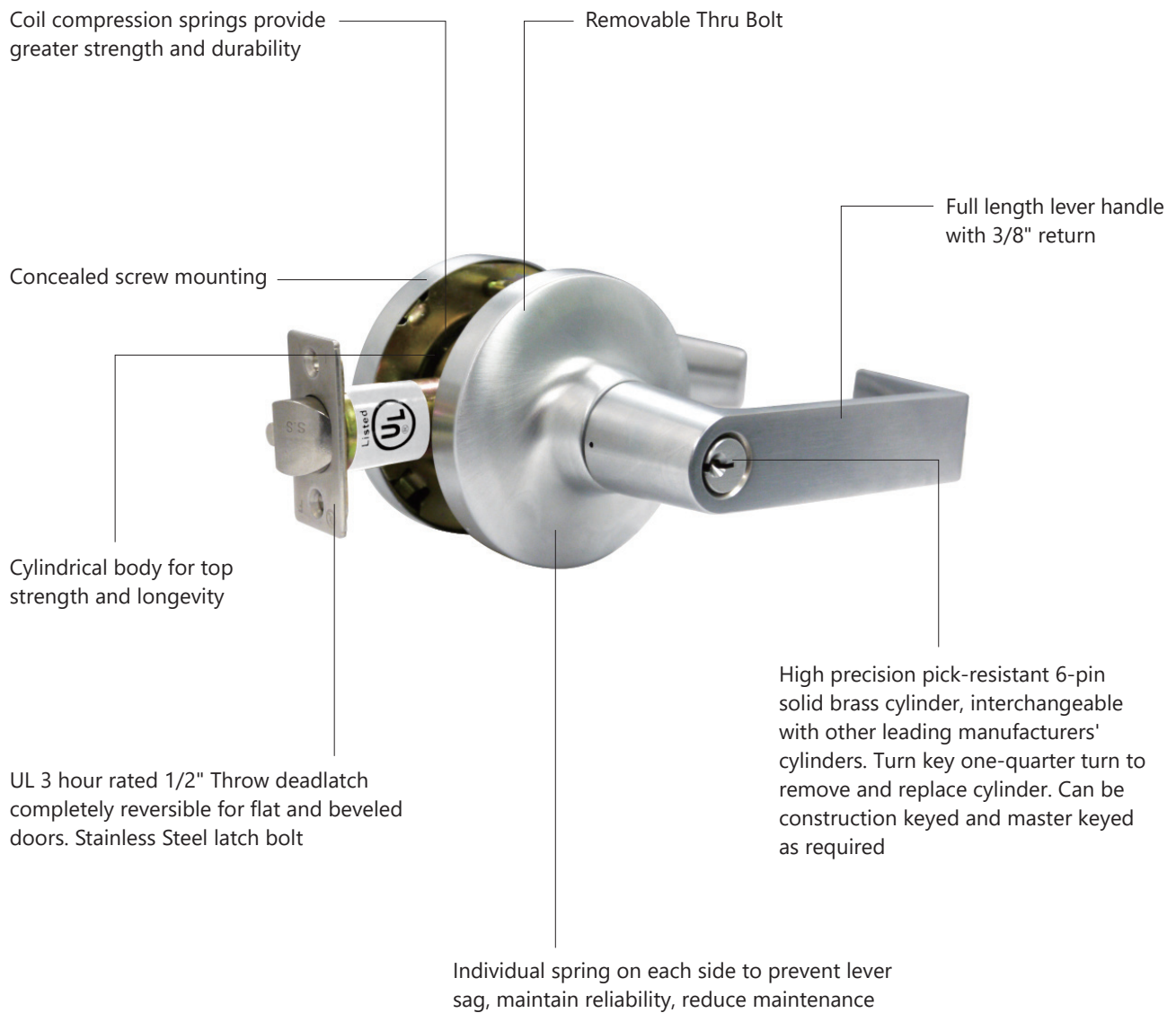

CL CYLINDRICAL LOCKSETS

Commercial Grade 1

SPECIFICATIONS

Door Thickness	1-3/8" (35mm) ~ 2" (51mm) standard doors
Door Prep	Crossbore 2-1/8" (54mm), Edgebore 1" (25mm), Latch face 2-1/4" (57mm) x 1-1/8" (28.6mm)
Backset	2-3/4" (70mm) standard 2-3/8" (60mm) optional
Cylinder	6-pin anti-pick, solid brass cylinder
Keys	Two (2) keys per lock. Schlage C keyway Keyed-Different standard Keyed-Alike, Construction key, Master key suite, or other keyways available by special order
Handing	Non-handed
Trim	Solid zinc diecast levers 55° lever rotation for full latch retraction
Clutch Function (CL)	Outside lever free wheeling while locked to prevent vandalism
Rose	3-9/16" (90mm) diameter Brass roses with concealed screws Threaded interior and exterior roses Removable thru bolts
Latchbolt	1/2" (12.7mm) throw, Stainless Steel 3 hour fire rated latchbolt Reversible for flat and beveled doors
Faceplate	2-1/4" (57mm) x 1-1/8" (28.6mm) square corner standard. Stainless Steel or brass faceplate
Strike	ANSI curved lip strike 4-7/8" (124mm) x 1-1/4" (32mm) x 1-1/4" (32mm) lip to center standard. Full lip strike or T strike available

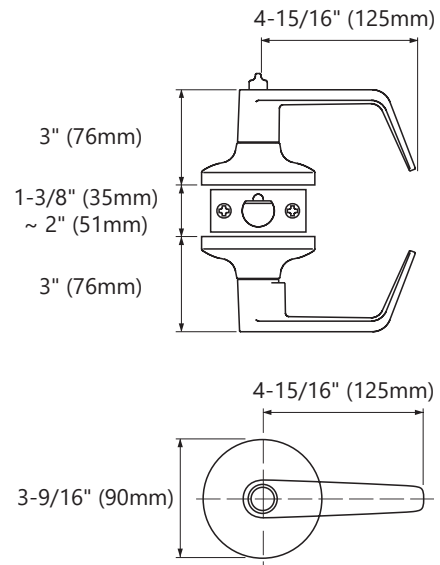

STANDARD FINISHES

- 10B Oil Rubbed Bronze
- 19G Graphite Black
- 26D Satin Chrome

For additional finish options not listed, contact Sales Department for MOQ and lead times

CODE COMPLIANCE



ANSI A156.2 Grade 1, UL 10C and UBC 7.2 for positive pressure
ANSI A117.1 ADA Barrier-free Accessibility
C-UBC California Uniform Builders Code-2001
NFPA-80 National Fire Protection-1999
NFPA-101 National Fire Protection-Life Safety-2000

CL LEVER DESIGNS



07 IN STOCK

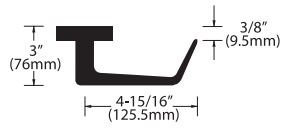

09 IN STOCK

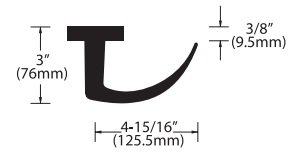

06 SPECIAL ORDER

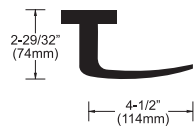

CL FUNCTIONS

Non Keyed Locks

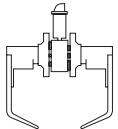

10 (ANSI: F75)

Passage Latch

Both levers are always unlocked from inside and outside

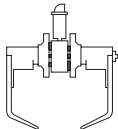

40 (ANSI: F76)

Privacy Lock

Outside lever is locked by push button inside
Outside lever is unlocked by emergency release outside, rotating inside lever or closing door
Inside lever is always free for emergency exit

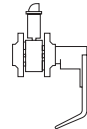

25 (ANSI: F111)

Exit/Communicating Lock

Inside lever is always unlocked
Blank plate outside
Inside lever is always free for emergency exit



17

Single Dummy Trim

Single dummy trim for one side

Keyed Locks

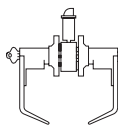

50 (ANSI: F82)

Entrance/Office Lock

Push button locks outside lever
Key outside releases push button, unlocking outside lever
Operating inside lever releases push button, unlocking outside lever
Inside lever is always free for emergency exit

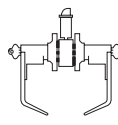

75 (ANSI: F110)

Intruder Classroom Lock

Outside lever is locked or unlocked by key from either side
When unlocked, the lockset works as a passage set
When locked, key required from either outside or inside to unlock the lockset
Inside lever is always unlocked for emergency exit

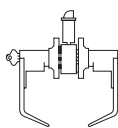

53 (ANSI: F109)

Entrance Lock

Push and turn button to keep outside lever locked. Key is always required to unlock the outside lever until button is reset
Push button only locks outside lever until it is unlocked by key or by turning inside lever
Key releases outside lever and push button inside, except when inside button is pushed and turned to keep outside lever locked
Inside lever always free for emergency exit

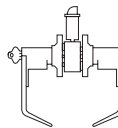

80 (ANSI: F86)

Storeroom Lock

Outside lever is unlocked only while key is turned
Inside lever is always free for emergency exit

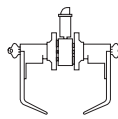

66 (ANSI: F91)

Store Door Lock

Key from either inside or outside locks or unlocks both levers
When unlocked, latch bolt operates by lever from either side

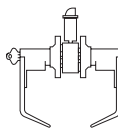

70 (ANSI: F84)

Classroom Lock

Outside lever is locked or unlocked by key
When unlocked the lockset works as a passage set
When locked, key required from outside to unlock the lockset
Inside lever is always unlocked for emergency exit

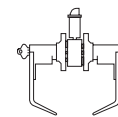

82 (ANSI: F87)

Institution Lock

Both levers are always inoperable
Entrance by key in lever from either side

CL DEAD LATCHES AND SPRING LATCHES



LSL06N
2-3/8" Spring Latch
1-1/8" Faceplate



LSL06K
2-3/8" Dead Latch
1-1/8" Faceplate



LSL07N
2-3/4" Spring Latch
1-1/8" Faceplate



LSL07K
2-3/4" Dead Latch
1-1/8" Faceplate

HOW TO ORDER

Stocked Grade 1 CL Cylindrical Locksets

For leversets using the same interior and exterior lever and finish combination: Stock items have shorter lead times.

Product	Lever	Function	Cylinder	Finish	Backset
CL	07	50	IC	26D	238
1	2	3	4	5	6

PRODUCT



CL

LEVER



07

09

06

FUNCTION

Non-Keyed Locks:

- 10 Passage Latch (F75)
- 40 Bath/Bedroom Privacy Lock (F76)
- 25 Exit/Communicating Lock (F111)
- 17 Single Dummy Trim

Keyed Locks:

- 50 Entrance/Office Lock (F82)
- 53 Entrance (F109)
- 70 Classroom Lock (F84)
- 75 Intruder Classroom Lock (F110)
- 80 Storeroom Lock (F86)
- 66 Store Door Lock (F91)
- 82 Institution Lock (F87)

4 CYLINDER

Blank Standard Cylinder in Lever/Knob 6 Pin Schlage C Keyway

IC With Small Format Interchangeable Cylinder SFIC 6 Pin Less Core*

* All IC Core i.e. construction core, combined core order separately.

5 FINISH

Standard:

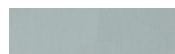

26D

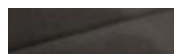

10B



19G

6 BACKSET

Blank = Standard 2-3/4" Backset

238 = 2-3/8" Backset

BL CYLINDRICAL LOCKSETS

Commercial Grade 2

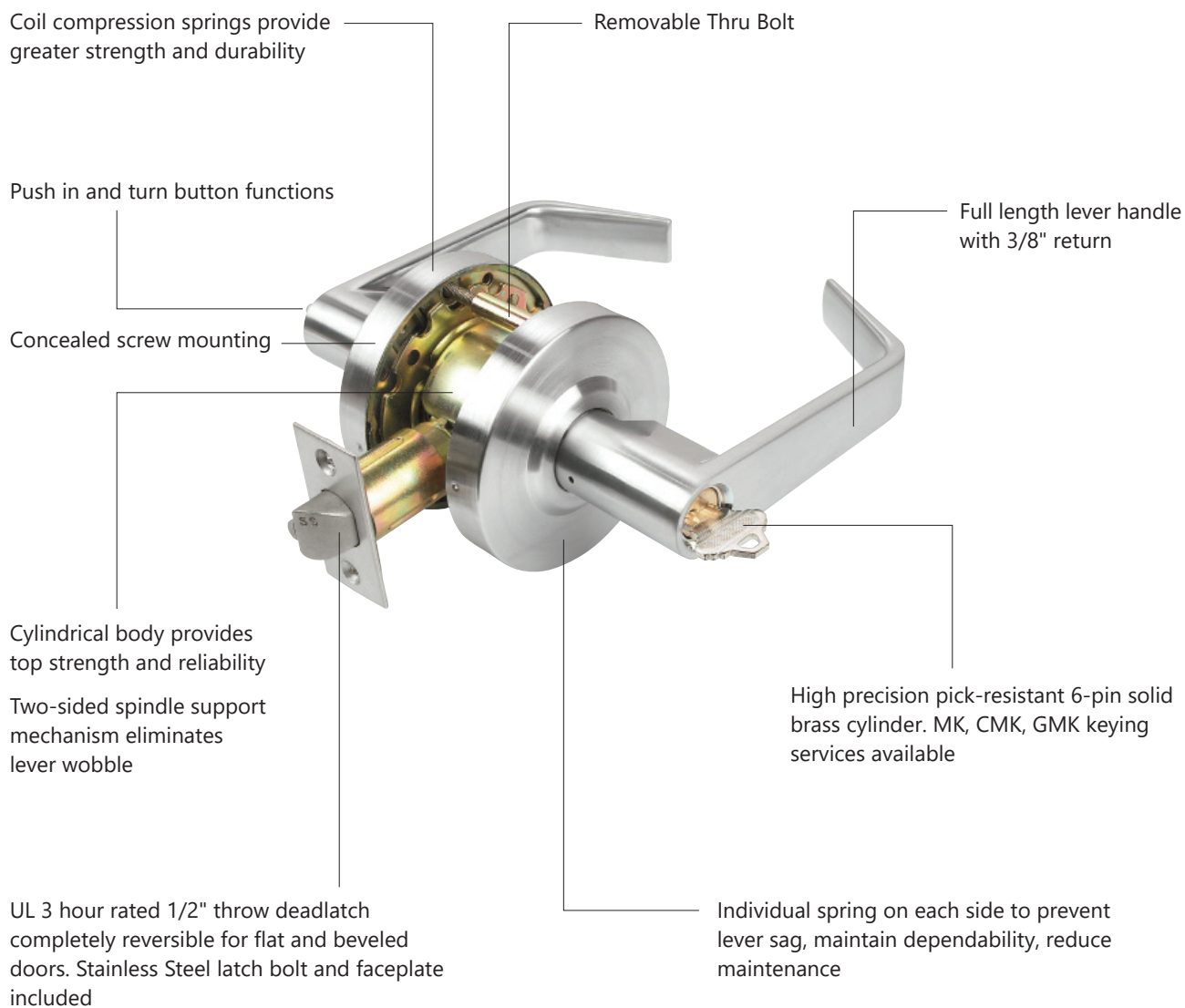

BL CYLINDRICAL LOCKSETS

Commercial Grade 2

SPECIFICATIONS

Door Thickness	1-1/2" (38mm) ~ 2" (51mm) standard doors
Door Prep	Standard 161 prep. w/optional thru-bolts Crossbore 2-1/8" (54mm) Edgebore 1" (25mm), Latch face 1-1/8" (28.6mm) x 2-1/4" (57mm)
Backset	2-3/4" (70mm) standard 2-3/8" (60mm) optional
Cylinder	6-pin anti-pick tumbler, solid brass cylinder
Keys	Two (2) keys per lock. Schlage C keyway Keyed-Different standard Keyed-Alike, Construction key, Master key suite, or other keyway available by special order
Handing	Non-handed
Trim	Solid zinc diecast levers 55° lever rotation for full latch retraction
Clutch Function (CL)	Outside lever free wheeling while locked to prevent vandalism
Rose	3-3/8" (86mm) diameter. Brass roses with concealed screws Threaded interior and exterior roses Removable thru bolts
Latchbolt	1/2" (12.7mm) throw, Stainless Steel 3 hour fire-rated latchbolt Reversible for flat and beveled doors
Faceplate	1-1/8" (28.6mm) x 2-1/4" (57mm) square corner standard. Stainless Steel or brass faceplate
Strike	ANSI curved lip strike 4-7/8" (124mm) x 1-1/4" (32mm) x 1-1/4" (32mm) lip to center standard. Full lip strike or T strike available

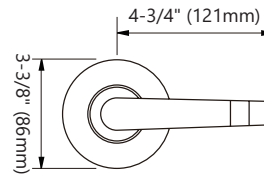

07 Lever

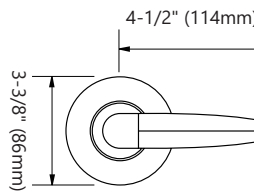
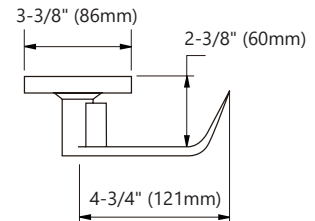

09 Lever

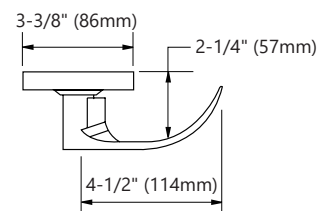

STANDARD FINISHES

- 10B Oil Rubbed Bronze
- 19G Graphite Black
- 26D Satin Chrome
- 26 Polished Chrome

For additional finish options not listed, contact Sales Department for MOQ and lead times

CODE COMPLIANCE



ANSI A156.2 Grade 1, UL 10C and UBC 7.2 for positive pressure
ANSI A117.1 ADA Barrier-free Accessibility
C-UBC California Uniform Builders Code-2001
NFPA-80 National Fire Protection-1999
NFPA-101 National Fire Protection-Life Safety-2000

BL LEVER DESIGNS



07 IN STOCK



09 IN STOCK

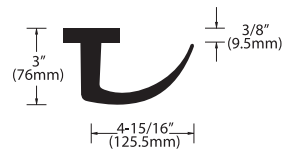

BL FUNCTIONS

Non Keyed Locks

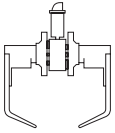

10 (ANSI: F75)

Passage Latch

Both levers are always unlocked from inside and outside

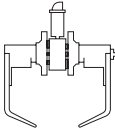

40 (ANSI: F76)

Privacy Lock

Outside lever is locked by push button inside
 Outside lever is unlocked by outside emergency release, rotating inside lever or closing door

Inside lever is always free for emergency exit

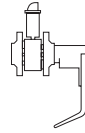

25 (ANSI: F111)

Exit/Communicating Lock

Inside lever is always unlocked
 Blank plate outside
 Inside lever is always free for emergency exit

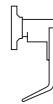

17

Single Dummy Trim

Single dummy trim for one side

Keyed Locks

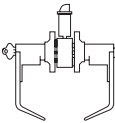

53 (ANSI: F109)

Entrance Lock

Push and turn button to keep outside lever locked. Key is always required to unlock the outside lever until button is reset
 Push button only locks outside lever until it is unlocked by key or by turning inside lever
 Key releases outside lever and push button inside, except when inside button is pushed and turned to keep outside lever locked
 Inside lever always free for emergency exit

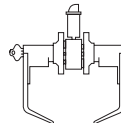

70 (ANSI: F84)

Classroom Lock

The outside lever is locked or unlocked by key
 When unlocked the lockset works as a passage set
 When locked, key required from outside to unlock the lockset
 The inside lever is always unlocked for emergency exit

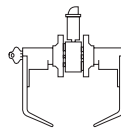

80 (ANSI: F86)

Storeroom Lock

Outside lever is unlocked only while key is turned
 Inside lever is always free for emergency exit

For additional finish options not listed, contact Sales Department for MOQ and lead times

BL DEAD LATCHES AND SPRING LATCHES



LSL01N
2-3/8" Spring Latch
1-1/8" Faceplate



LSL01K
2-3/8" Dead Latch
1-1/8" Faceplate



LSL02N
2-3/4" Spring Latch
1-1/8" Faceplate



LSL02K
2-3/4" Dead Latch
1-1/8" Faceplate

HOW TO ORDER

Stocked Grade 2 BL Cylindrical Locksets

For leversets using the same interior and exterior lever and finish combination: Stock items have shorter lead times.

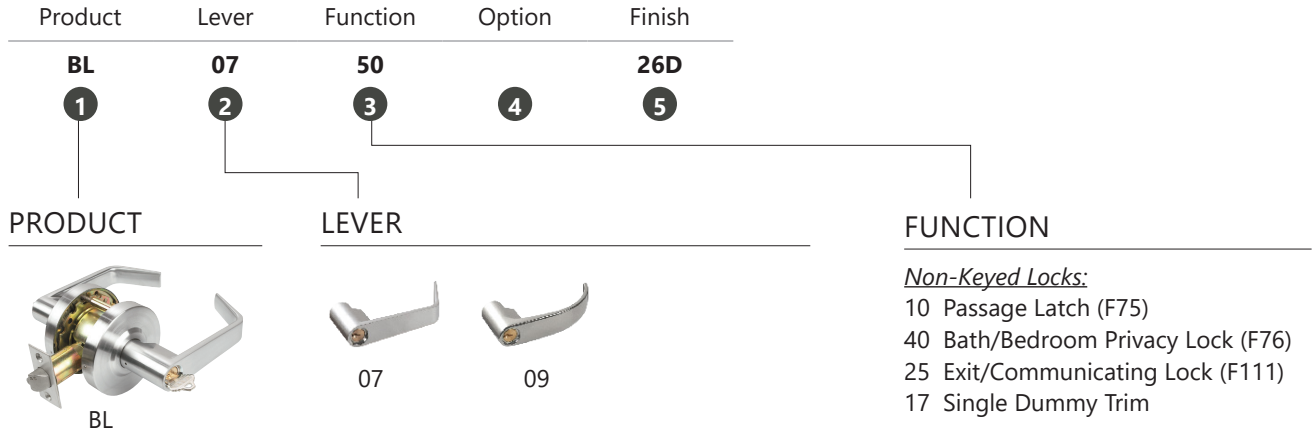

④ OPTION

- Blank Non-clutch
- CL Clutch (BL Series Only)

⑤ FINISH



CX DEADBOLT

Commercial Grade 1

ADA ergonomic solid brass thumbturn

2-1/2" diameter solid forged brass anti-torque housing design. Exceeds ANSI Grade 1 security against hammer and crowbar prying attacks



1" (25mm) throw solid brass deadbolt with hardened steel core. Exceeds ANSI Grade 1 Security against kick-in and saw attacks

High precision pick-resistant solid brass 6 pin cylinder with anti-drill ball bearings in "C" Keyway. Meets ANSI Grade 1 Security. Brass Keys included

Strong all steel latch case and mechanism

CX HEAVY DUTY DEADBOLT

CX Deadbolt Grade 1

SPECIFICATIONS

Door Thickness	1-9/16" (40mm) ~ 2" (51mm) doors standard
Backset	2-3/8" (60mm) or 2-3/4" (70mm)
Handing	Non-handed
Exposed Trim	2-1/2" (63.5mm) diameter solid brass, one-piece design exceeds BHMA/ANSI Grade 1 security against hammer and crowbar prying attacks
Faceplate	1-1/8" (28.6mm) x 2-1/4" (57mm) with square corners; Stainless Steel or brass faceplate
Dead Bolt	1" (25mm) throw deadbolt with saw-resistant hardened steel core
Strike	1-1/8" (28.6mm) x 2-3/4" (70mm) with steel reinforcement
Cylinder & Keys	6-pin anti-pick cylinder in Schlage C keyway keyed different with 2 brass keys per lock. Small Format Interchangeable Core (SFIC) available by specifying IC core; please order separately
Keying Options	Keyed Alike, Master keying, Grand Master Keying, and Construction Keying available by special order. Nickel silver keys available by special order

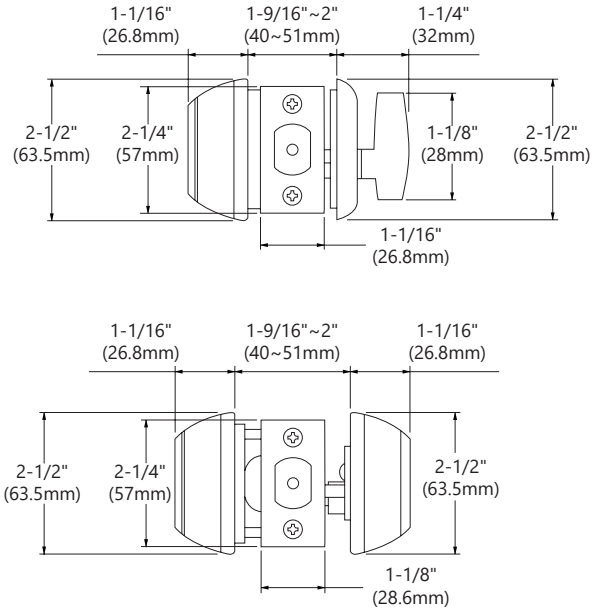

STANDARD FINISHES

- 10B Oil Rubbed Bronze
- 19G Graphite Black
- 26D Satin Chrome

For additional finish options not listed, contact Sales Department for MOQ and lead times

CODE COMPLIANCE



ANSI/BHMA A156.36 & A156.5 Grade 1
 UL Listed for UL10B and UL10C, up to 3 Hours
 UBC Standard 7-2 (1997) NFPA 252
 NFPA 80 National Fire Protection-Fire Door Assembly
 NFPA101 National Fire Protection-Life Safety
 ANSI/BHMA A156.18 Finishes
 ANSI A117.1 ADA Accessibility

BX DEADBOLT

Commercial Grade 2

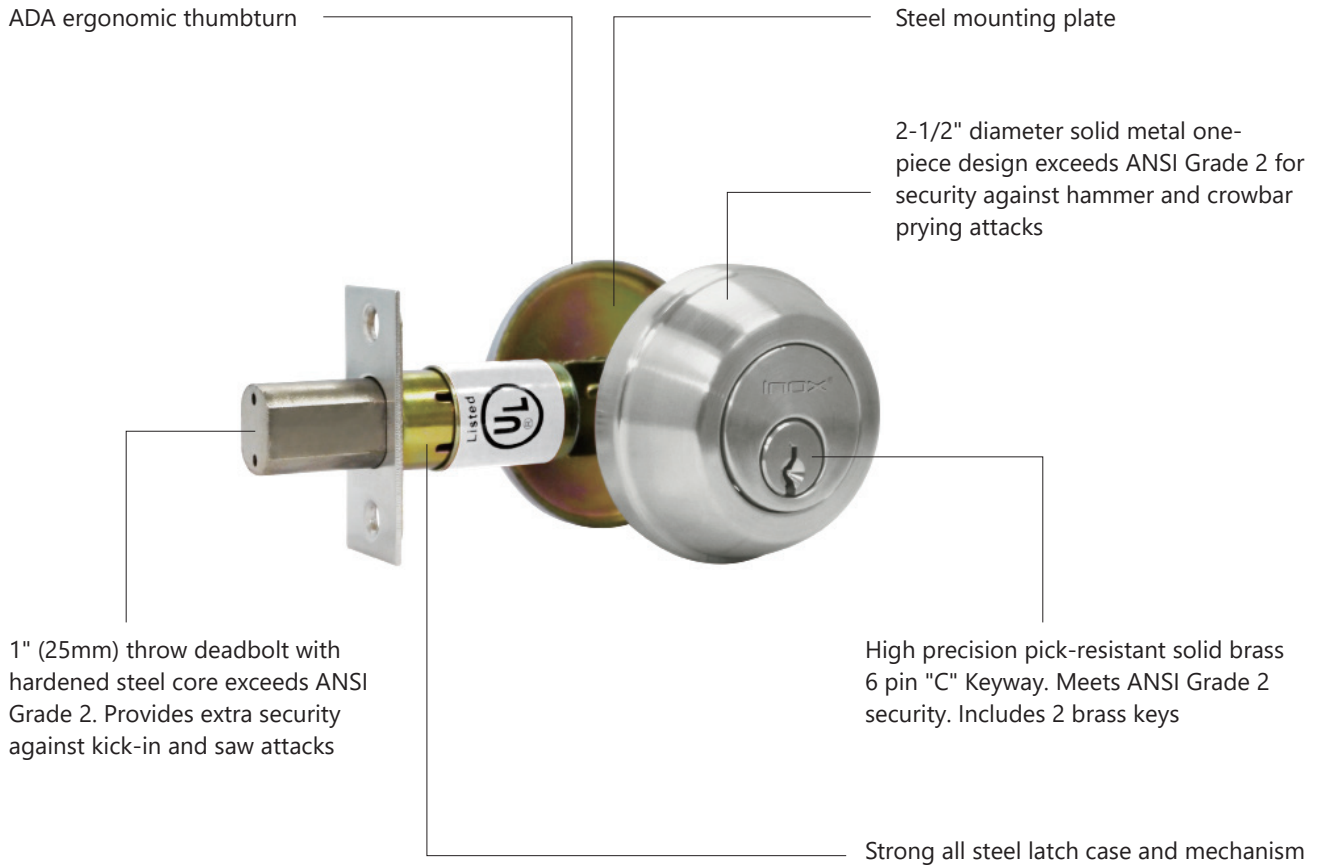

BX STANDARD DUTY DEADBOLT

Commercial Grade 2

SPECIFICATIONS

Door Thickness	1-3/8" (35mm) ~ 2" (51mm) doors standard
Backset	2-3/8" (60mm) or 2-3/4" (70mm)
Handing	Non-handed
Exposed Trim	2-1/2" (63.5mm) diameter solid cast alloy, one-piece design exceeds BHMA/ANSI Grade 2 security against hammer and crowbar prying attacks
Faceplate	1-1/8" (28.6mm) x 2-1/4" (57mm) Stainless Steel or brass faceplate with square corners radius corner available by special order
Dead Bolt	1" (25mm) throw deadbolt with saw-resistant hardened steel core
Strike	1-1/8" (28.6mm) x 2-3/4" (70mm) with steel reinforcement
Cylinder & Keys	6-pin anti-pick cylinder in Schlage C keyway keyed different with 2 brass keys per lock. Small Format Interchangeable Core (SFIC) available by specifying IC core, please order separately
Keying Options	Keyed Alike, Master Keying, Grand Master Keying, and Construction Keying available by special order. Nickel silver keys available by special order

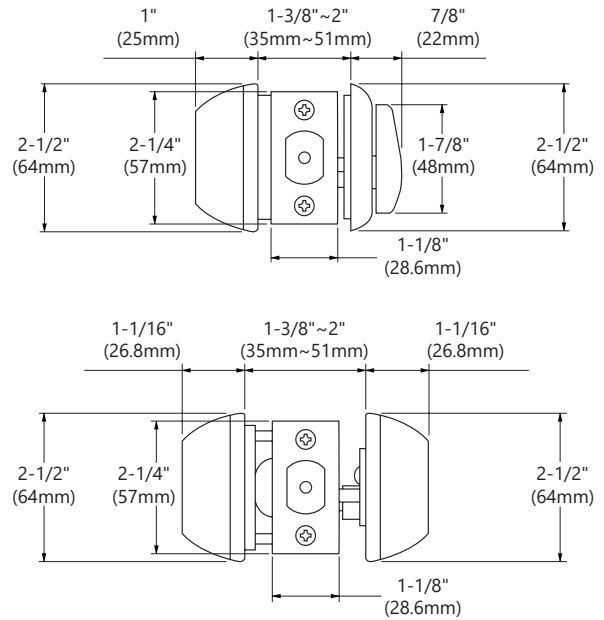

STANDARD FINISHES

- 10B Oil Rubbed Bronze
- 19G Graphite Black
- 26D Satin Chrome
- 26 Polished Chrome

For additional finish options not listed, contact Sales Department for MOQ and lead times

CODE COMPLIANCE



ANSI/BHMA A156.36 & A156.5 Grade 2
 UL Listed for UL10B and UL10C, up to 3 Hours
 UBC Standard 7-2 (1997) NFPA 252
 NFPA80 National Fire Protection-Fire Door Assembly
 NFPA101 National Fire Protection-Life Safety
 ANSI/BHMA A156.18 Finishes
 ANSI A117.1 ADA Accessibility

CX/BX FUNCTIONS

CX Deadbolt Grade 1

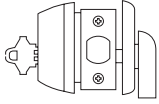

CX660 (ANSI: E1251)

Single Cylinder

Deadbolt thrown or retracted by key outside or thumbturn inside
Bolt automatically deadlocks when fully thrown

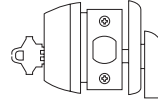

CX663 (ANSI: E2171)

Classroom Deadbolt

Deadbolt thrown by key outside only
Deadbolt retracted by key outside or thumbturn inside

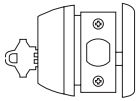

CX661 (ANSI: E2161)

Cylinder Only x Blank Plate

Deadbolt thrown or retracted by key outside
Blank plate with exposed screws inside

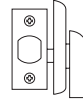

CX680 (ANSI: E2191)

Door Bolt

Deadbolt operated by thumbturn only. No outside trim. Bore halfway through door for installation visible from one side of door only

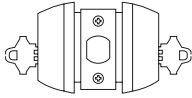

CX662 (ANSI: E2141)

Double Cylinder

Deadbolt thrown or retracted by key from either side
Bolt automatically deadlocks when fully thrown

BX Deadbolt Grade 2

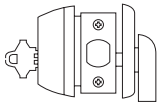

BX600 (ANSI: E0152)

Single Cylinder

Deadbolt thrown or retracted by key outside or thumbturn inside
Bolt automatically deadlocks when fully thrown

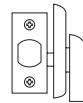

BX680 (ANSI: E0192)

Door Bolt

Deadbolt operated by thumbturn only. No outside trim. Bore halfway through door for installation visible from one side of door only

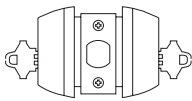

BX662 (ANSI: E0142)

Double Cylinder

Deadbolt thrown or retracted by key from either side
Bolt automatically deadlocks when fully thrown

HOW TO ORDER

Stocked Cylindrical Deadbolts

Product	Function	Cylinder	Finish	Keying
CX	660	IC	26D	KA
1	2	4	5	6

PRODUCT



CX Series Grade 1 Bored Deadbolt Locks



BX Series Grade 2 Bored Deadbolt Locks

FUNCTION

- 660 Single Cylinder Deadbolt (E2151)
- 661 Cylinder Only x Blank Plate (E2161) - CX only
- 662 Double Cylinder Deadbolt (E2141)
- 663 Classroom Deadbolt (E2171) - CX only
- 680 Door Bolt (E2191)

4 CYLINDER

- Blank Standard Cylinder 6 Pin Schlage C Keyway
- IC With Small Format Interchangeable Cylinder Less Core*
- * All IC Core, e.g. construction or combined core, order separately

5 FINISH

Standard:

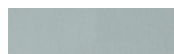

26D

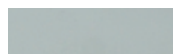

26

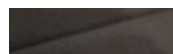

10B



19G

RIM CYLINDERS

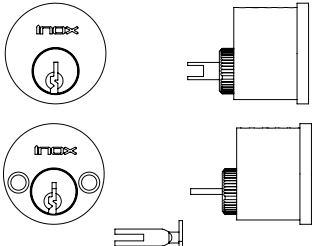
Illustration	Item Code	Description	ANSI
	CRB106	Single Cylinder in Lever, 6 Pin with Tailpiece, Schlage C Keyway 2 Keys, Standard Keyed Different (KD). Other Keying Services are available.	E09221
	CRB106F CRB106HR	Double Cylinder in Lever, 6 Pin with Tailpiece, Schlage C Keyway 2 Keys, Standard Keyed Different (KD). Other Keying Services are available.	E09221

STANDARD CYLINDER

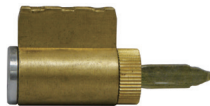
Illustration	Item Code	Description	ANSI
	CYSC10	Standard Cylinder in Lever, 6 Pin Schlage C Keyway	E09231

SMALL FORMAT INTERCHANGEABLE CORE (SFIC) HOUSING WITH TAILPIECE

Illustration	Item Code	Description	ANSI
	CRB1126-SFIC-HUS	Housing with Tailpiece	E09261

INTERCHANGEABLE CORES ONLY

- Solid brass plug and housing
- Small Format (SFIC) Core in Best A Keyway
- 6 or 7 pin cores replace Arrow, Best, Falcon
- Construction or Combined Core
- 1 Control key per group/order
- 2 Change keys per Combined Core – A2 System Only
- 1 Master Key or Grand Master key per group/order
- US26D finish only

Illustration	Item Code	Description	ANSI
	CMB-ICBA6-CST	SFIC Core Only, Best A Keyway, 6 Pin, Construction	E09251
	CMB-ICBA6-CMB	SFIC Core Only, Best A Keyway, 6 Pin, Combined	E09251
	CMB-ICBA7-CMB	SFIC Core Only, Best A Keyway, 7 Pin, Combined	E09251

KEYS

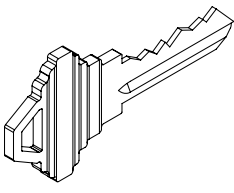
Illustration	Item Code	Description
	LSK-6SC-NP	Standard Key, Schlage C Keyway for 6 Pin, Nickel Plated
	LSK01-6SC-NS-DND	DND Nickel Silver Key, Schlage C Keyway for 6 Pin, w/“Do Not Duplicate”
	LSK06-BA-CRK	Extra Control Key for IC Core, Best A Keyway
	LSK06-BA-MK	Extra Master Key for IC Core, Best A Keyway
	LSK06-BA-GMK	Extra Grand Master Key for IC Core, Best A Keyway

KEYING SERVICES

Description	Item No.
Service: Key Cut including Key Blank	SV-KYCT
Service: Keyed Alike (KA)	SV-KA
Service: Keyed Alike Pair	SV-KA2
Service: Keyed Alike Group (Specify Number of Keyed Alike Per Group)	SV-KASN
Service: Keyed to Specific Code	SV-KS
Service: Master Keying	SV-MK
Service: Grand Master Keying with 2 or more Master groups.	SV-GMK
Service: Construction Master Keying Service	SV-CMK
Service: Great Grand Master Key	SV-GGMK

Description	Item No.
Service: IC Core Key Cut including Key Blank	SV-ICKYCT
Service: IC Core Keyed Alike (KA) - Each cylinder in the group is keyed alike	SV-ICKA
Service: IC Core Keyed to Specific Code - Cylinder is keyed to a specific code	SV-ICKS
Service: IC Core Master Keying - 2 Change Keys per Cylinder and 3 Master Keys per MK	SV-ICMK
Service: IC Core Grand Master Keying (2 or more MK groups included)	SV-ICGMK
Service: IC Core Master Keying, 2 Change Keys Per Cyl, and 3 Master Keys per MK Group	SV-ICMK

STRIKE

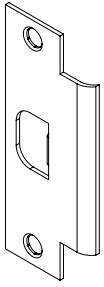

LSR-ASA
ASA Strike (ANSI Standard)
1-1/4"x4-7/8"

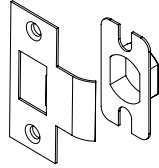

LSR-T1
T- Strike
1-1/8" x 2-3/4"
w/lip 1-1/2"x1/2"

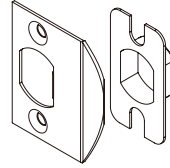

LSR-D1
Full-lip Strike
1-3/4"x2-1/4"

DEADBOLT AND STRIKES

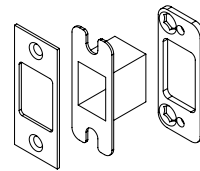
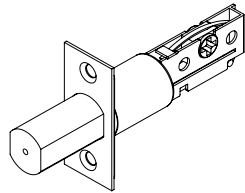

Deadbolt Strike 1-1/8" (28mm) x 2-3/4" (70mm) with reinforcement plate, dustbox and 3" (76mm) screws

Backset	Grade 1	Grade 2
2-3/8"	BT360F	BT160F
2-3/4"	BT370F	BT170F

ELECTRIFICATION OF LOCKS

Description	Item No.
SERVICE CODE: Electrification of Cylindrical Lock, Fail Safe 12V Voltage	SV-CL-EL12V
SERVICE CODE: Electrification of Cylindrical Lock, Fail Safe 24V Voltage	SV-CL-EL24V
SERVICE CODE: Electrification of Cylindrical Lock, Fail Secure 12V Voltage	SV-CL-EU12V
SERVICE CODE: Electrification of Cylindrical Lock, Fail Secure 24V Voltage	SV-CL-EU24V
SERVICE CODE: Electrification of Cylindrical Lock, Fail Safe 12V Voltage with REX Switch	SV-CL-EL12V-REX
SERVICE CODE: Electrification of Cylindrical Lock, Fail Safe 24V Voltage with REX Switch	SV-CL-EL24V-REX
SERVICE CODE: Electrification of Cylindrical Lock, Fail Secure 12V Voltage with REX Switch	SV-CL-EU12V-REX
SERVICE CODE: Electrification of Cylindrical Lock, Fail Secure 24V Voltage with REX Switch	SV-CL-EU24V-REX

Add service code and upcharge price as a separate line item to order electrified locking (EL) locks. In case of power outage, EL locks are Fall Safe and EU locks are Fail Secure.

INOX CL Cylindrical Lock CROSS REFERENCES

ANSI No. Grade 1	Function	INOX®	Dorma	Schlage	Hager	Cal-Royal
F75	Passage	CL10	C110	ND10S	3410	GN-30
F76	Privacy	CL40	C140	ND40S	3440	CGN-20
F111	Exit/Communicating	CL25	C125	ND25	-	-
F109	Entrance	CL53	C153	ND53PD	3453	CGN-00
F84	Classroom	CL70	C170	ND70PD	3470	CGN-03
F110	Intruder Classroom	CL75	C177	-	3495	CGN-07
F86	Storeroom	CL80	C180	ND80PD	3480	CGN-04
F91	Store Door	CL66	C166	ND66	-	CGN-02
F87	Institution	CL82	C182	ND82PD	-	CGN-09
-	Dummy	CL17	C101	ND170	3417	GN-40

INOX BL Cylindrical Lock CROSS REFERENCES

ANSI No. Grade 2	Function	INOX®	Dorma	Schlage	Hager	PDQ	Cal-Royal
F75	Passage	BL--10	C510	AL10S	3510	SP126	CSL-30
F76	Privacy	BL--40	C540	AL40S	3540	SP176	CSL-20
F109	Entrance	BL--53	C553	AL53PD	3553	SP116	CSL-00
F84	Classroom	BL--70	C570	AL70PD	3570	SP148	CSL-03
F86	Storeroom	BL--80	C580	AL80PD	3580	SP115	CSL-04
-	Exit	BL--25	C525	AL25PD	-	-	CSL-04
-	Dummy	BL--17	C501	AL170PD	3417	SP211	CSL-40

INOX CX Grade 1 Deadbolt CROSS REFERENCES

ANSI Ref.	Function	INOX®	Dorma	Schlage	Hager	Cal-Royal
E2151	Single Cylinder	CX660	D860	B660P	3115	CRB800
E2161	Cylinder Only x Blank Plate	CX661	D861	B661P	-	-
E2141	Double Cylinder	CX662	D862	B662P	3114	CRB700
E2171	Classroom	CX663	D863	B663P	3118	CRB600
E2191	Door Bolt	CX680	-	B680	-	-

INOX BX Grade 2 Deadbolt CROSS REFERENCES

ANSI Ref.	Function	INOX®	Dorma	Schlage	Hager	Cal-Royal
E0152	Single Cylinder	BX660	D660	B560P	3215	ULT360
E0142	Double Cylinder	BX662	D662	B562P	3214	ULT362
E0192	Door Bolt	BX680	-	B580	-	ULID365

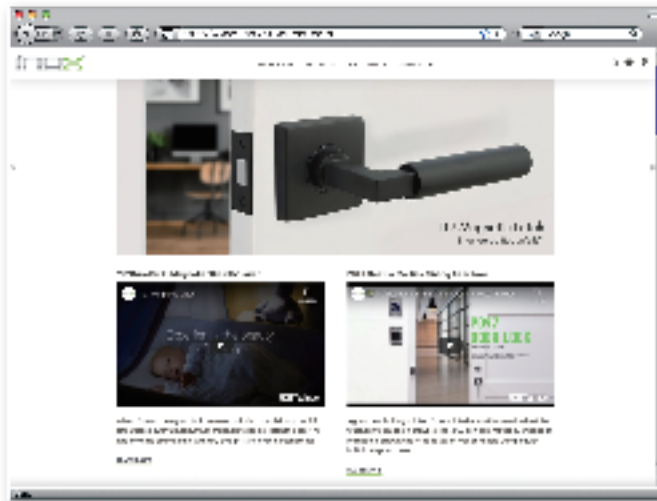

Please visit our website
www.inoxproducts.com
for more technical and new product information.

Unison Hardware, Inc.
6 Wayne Court, Sacramento CA 95829, USA Tel: +1.916.388.1888
Email: info@unisonhardware.com